

**Make: SEAT Sport**
**Model: SEAT Leon Cup Racer V1 / DSG**

## TECHNICAL FORM TCN2

 Certification valid as from: **08 APRIL 2016**

Homologation form only valid for cars in  
Compliance with the SAFETY CAGE  
CERTIFICATE HES4441013

### 1. GENERAL

#### 101. MANUFACTURER

**SEAT**

#### 102. MODEL AND TYPE

a) Model and type	<b>LEON</b>	
b) Typical chassis number	<b>VSSMK35F4XSSPXXXX</b>	<b>X = VARIABLE DIGITS</b>

#### 103. CYLINDER CAPACITY

Cylinder capacity	<b>1984</b>		cm <sup>3</sup>
Corrected cylinder capacity	<b>1984</b>	<b>X 1.7</b>	<b>= 3372.8</b> cm <sup>3</sup>

A1) Race Car seen from 3/4 front



A2) Race Car seen from 3/4 rear



A3) Race Car seen from 3/4 front and below



A4) Race Car seen from 3/4 rear and below





# REAL FEDERACIÓN ESPAÑOLA DE AUTOMOVILISMO

Certification N°

TCN2 - C - 001

Make: **SEAT SPORT**

Model: **SEAT Leon Cup Racer V1 / DSG**



REAL FEDERACIÓN ESPAÑOLA DE AUTOMOVILISMO Extension N°  
Departamento Técnico  
Technical Department

## 2. DIMENSIONS, WEIGHT

### 202. OVERALL LENGTH

a) Overall:	<b>4547</b>	± 10 mm
b) at bumpers:	<b>4353</b>	± 10 mm

### 203. OVERALL WIDTH

<b>1950</b> mm	-1%
Measurement point:	Front and rear axle centreline

### 204. WIDTH OF BODYWORK

a) At front axle centreline	<b>1950</b>	mm	-1%
b) At rear axle centreline	<b>1950</b>	mm	-1%

### 206. WHEELBASE

<b>2665</b> mm	± 10 mm
----------------	---------

### 209. OVERHANG

a) Front	<b>897</b>	± 10 mm
Front at bumper	<b>868</b>	± 10 mm
b) Rear	<b>985</b>	± 10 mm
Rear at bumper	<b>820</b>	± 10 mm

### 210. MINIMUM WEIGHT

<b>1150</b>	kg
-------------	----

## 3. ENGINE

Model and origin of the engine	Identification: <b>CJX-</b>	Original car: <b>SEAT LEON CUPRA</b>
--------------------------------	-----------------------------	--------------------------------------

### 301. LOCATION AND POSITION OF THE ENGINE

	X =	<b>380</b>	± 5 mm
b) Position	Y =	<b>343,5</b>	± 5 mm
	Z =	<b>229</b>	± 3 mm
c) Inclination		<b>102</b>	- 2°

See scheme **III-A1)**

C0-1) Reference point



C0-2) Engine serial number



**302. ENGINE SUPPORTS**

 Number: **3**

 Material: **Steel**
**303. CYCLE**
**Otto**
**304. SUPERCHARGING**

Type and number of compressors

**1 Turbo charger**
**307. CYLINDER CAPACITY**

a) Unitary	<b>496</b>	cm <sup>3</sup>
b) Total	<b>1984</b>	cm <sup>3</sup>
c) Maximum total allowed	<b>1984.2</b>	cm <sup>3</sup>

**310. COMPRESSION RATIO (IN RELATION WITH THE UNIT)**

 Maximum (Otto engine): **9.3** : 1

**314. BORE**
**82.5 mm** +0  
 - 0.1 mm

**316. STROKE**
**92.8 mm** +0  
 - 0.1 mm

C0-3) Engine position in the car seen from above



C0-4) Engine position in the car seen from below

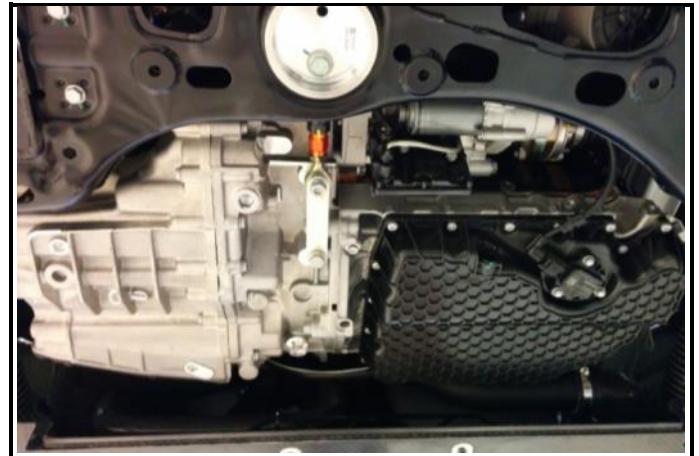

Make: **SEAT SPORT**

Model: **SEAT Leon Cup Racer V1 / DSG**



REAL FEDERACIÓN ESPAÑOLA DE AUTOMOVILISMO Extension N°  
Departamento Técnico  
Technical Department

C1-1) Dismounted engine – seen from  $\frac{3}{4}$  the rear & above

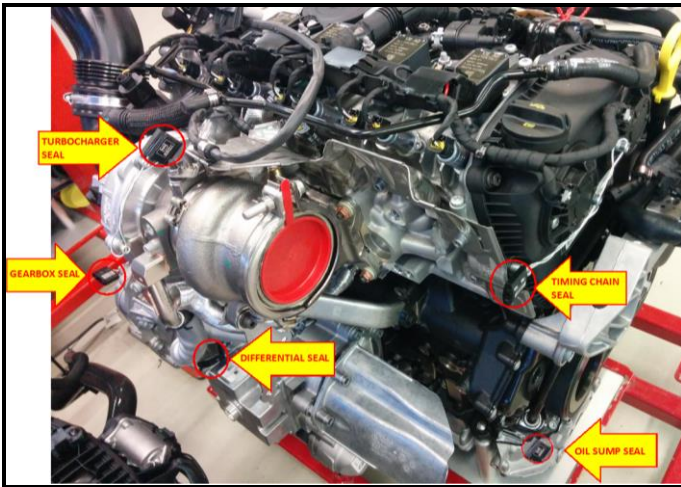

C1-2) Dismounted engine – seen from  $\frac{3}{4}$  the rear & below

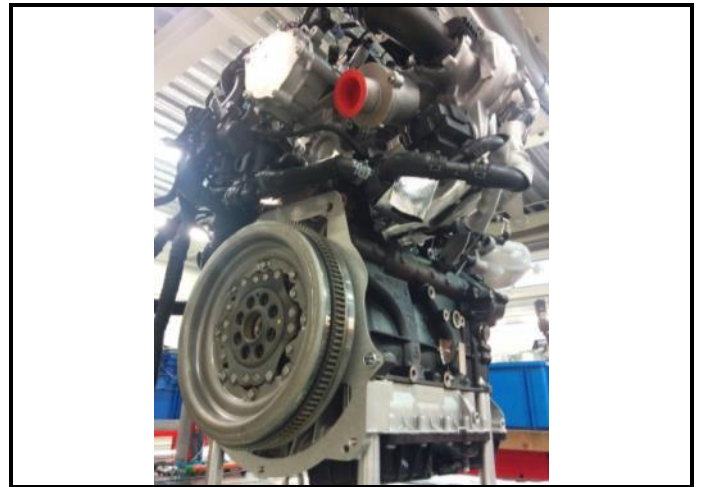

III-A1)

POSITION OF THE ENGINE

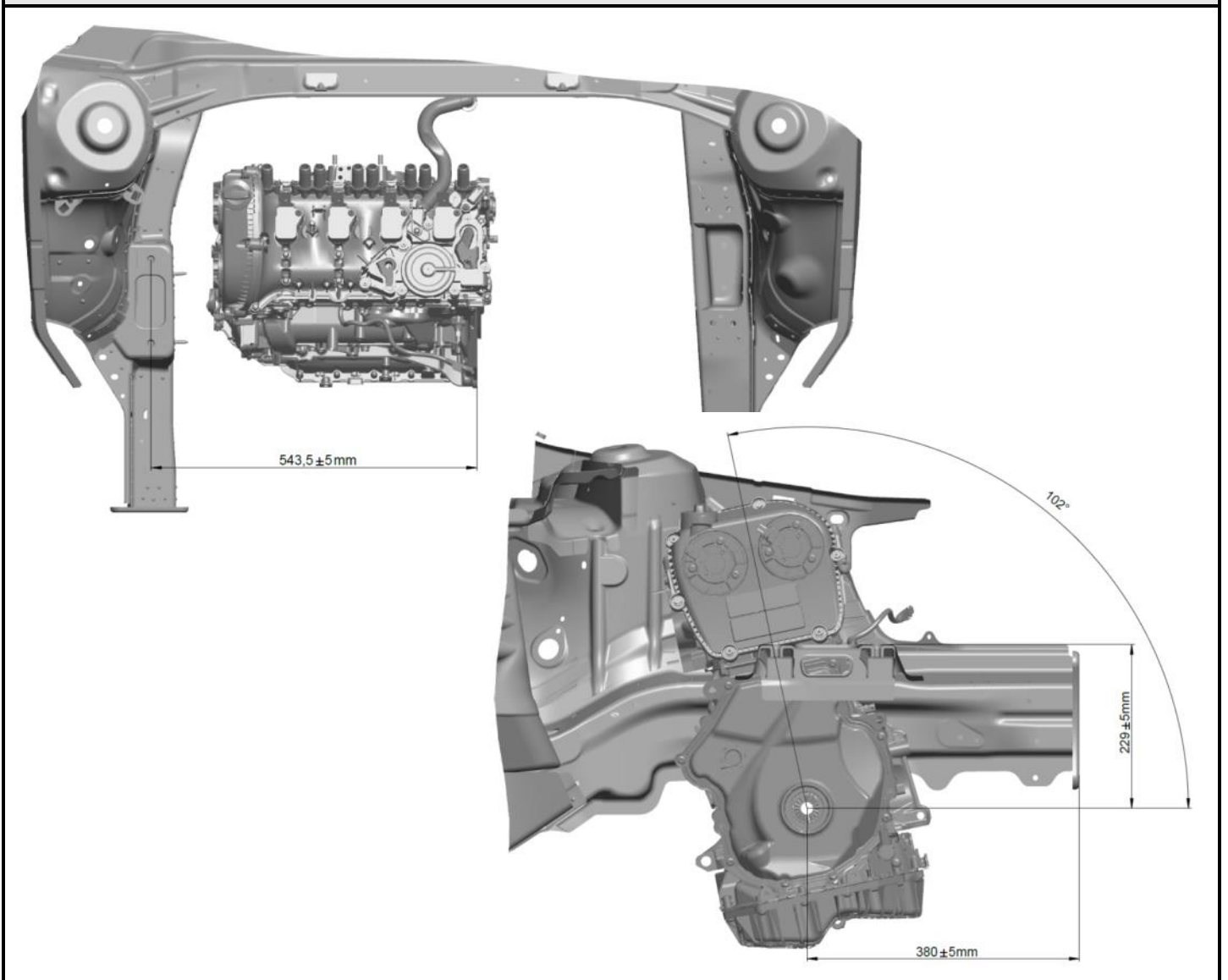

C2-1) Engine support 1 dismounted (photo)

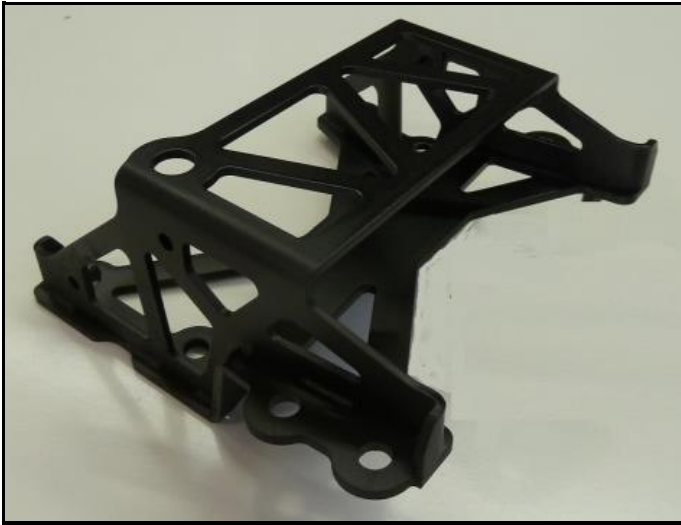

III-B1) Engine support 1

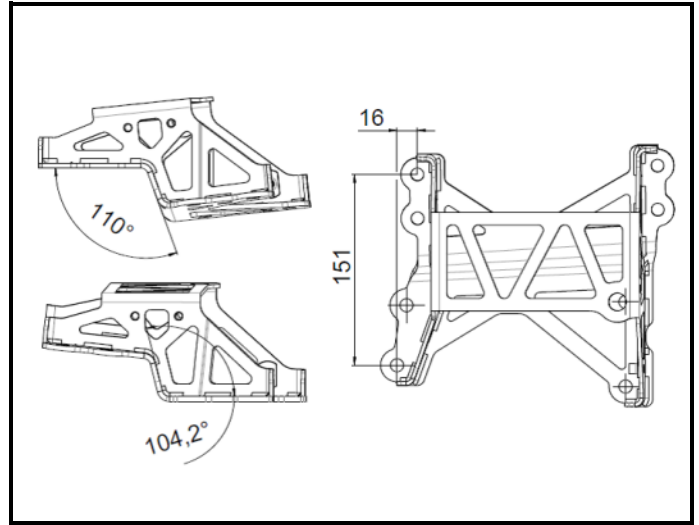

C2-2) Engine support 2 dismounted (photo)



III-B2) Engine support 2

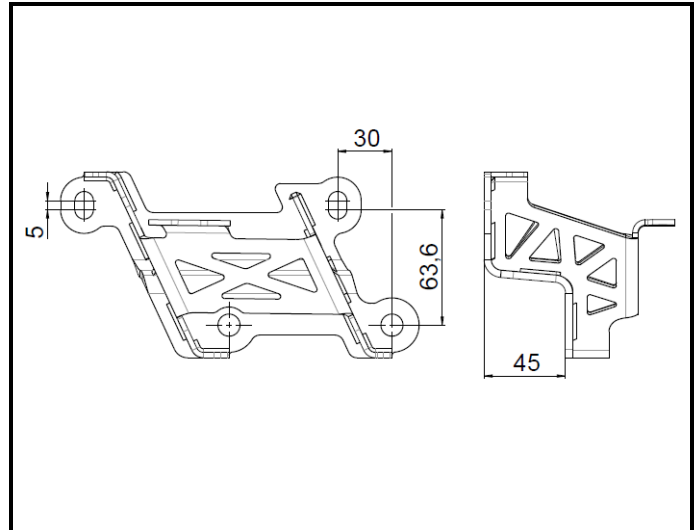

C2-3) Engine support 3 dismounted (photo)



III-B3) Engine support 3

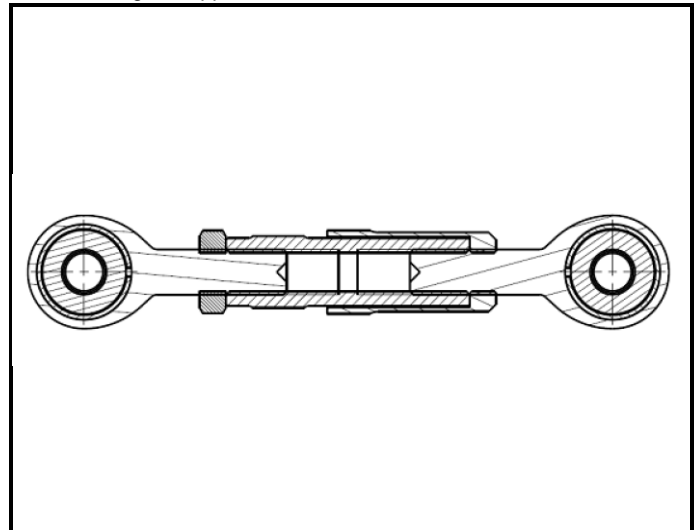



# REAL FEDERACIÓN ESPAÑOLA DE AUTOMOVILISMO

Certification N°

TCN2 - C - 001

Make: **SEAT SPORT**

Model: **SEAT Leon Cup Racer V1 / DSG**



REAL FEDERACIÓN ESPAÑOLA DE AUTOMOVILISMO Extension N°  
Departamento Técnico  
Technical Department

## 311. CYLINDER BLOCK BELONGING TO EA888 ENGINE

a) Material

c) Minimum weight

g

Without crankshaft bearings caps, with fixing studs (bearing caps, cylinder head and oil sump)

C3-1) Bare cylinder block seen from above



C3-2) Bare cylinder block seen from underneath

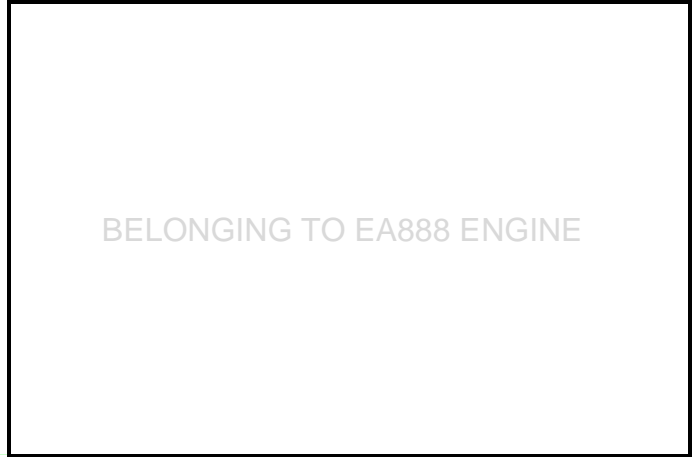

C3-3) Bare cylinder block seen from right hand side



C3-4) Bare cylinder block seen from left hand side



C3-5) Bare cylinder block seen from timing side

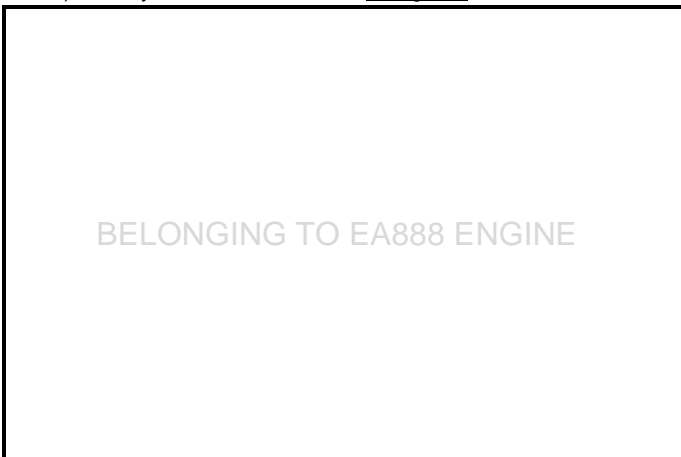

C3-6) Bare cylinder block seen from flywheel side

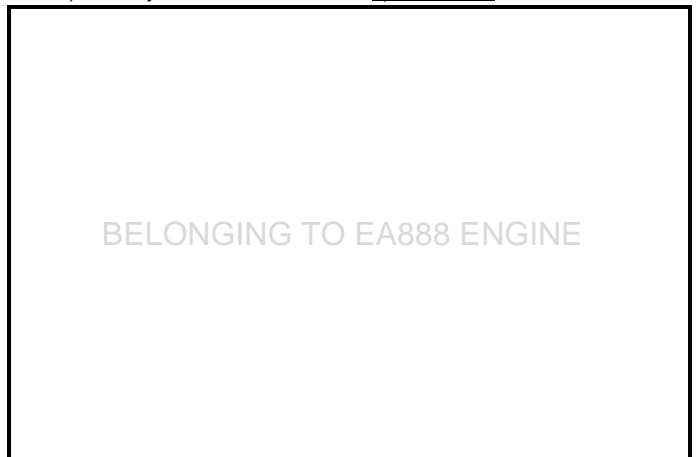



# REAL FEDERACIÓN ESPAÑOLA DE AUTOMOVILISMO

Certification N°

TCN2 - C - 001

Make: **SEAT SPORT**

Model: **SEAT Leon Cup Racer V1 / DSG**



REAL FEDERACIÓN ESPAÑOLA DE AUTOMOVILISMO Extension N°  
Departamento Técnico  
Technical Department

C3-7) Crankshaft bearing caps

C3-7b) Crankshaft bearing caps

BELONGING TO EA888 ENGINE

BELONGING TO EA888 ENGINE

## 312. MIN. HEIGHT OF THE CYLINDER BLOCK

III-C1) Height measurement

a) Between sump and head gasket planes mm

b) Between crankshaft centreline and head gasket plane mm

BELONGING TO EA888 ENGINE

## 313. SLEEVES

a) Sleeved cylinder block **Yes**  **No**

b) Material

c) Type:

C3-8) Sleeve dismantled

BELONGING TO EA888 ENGINE



# REAL FEDERACIÓN ESPAÑOLA DE AUTOMOVILISMO

Certification N°

TCN2 - C - 001

Make: **SEAT SPORT**

Model: **SEAT Leon Cup Racer V1 / DSG**



REAL FEDERACIÓN ESPAÑOLA DE AUTOMOVILISMO Extension N°  
Departamento Técnico  
Technical Department

## 317. PISTON BELONGING TO EA888 ENGINE

- a) Material
- b) Number of rings
- c) Minimum weight g
- d1) Minimum compression height
- b1) Thickness of rings + 0.1  
-0.05 mm
- With pin, bearing, clips and rings mm

C4-1) Piston from  $\frac{3}{4}$  top

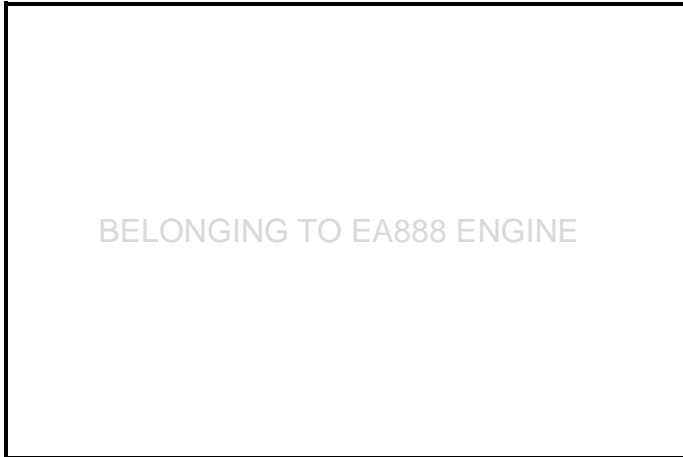

C4-2) Piston from  $\frac{3}{4}$  bottom



C4-1) Piston rings

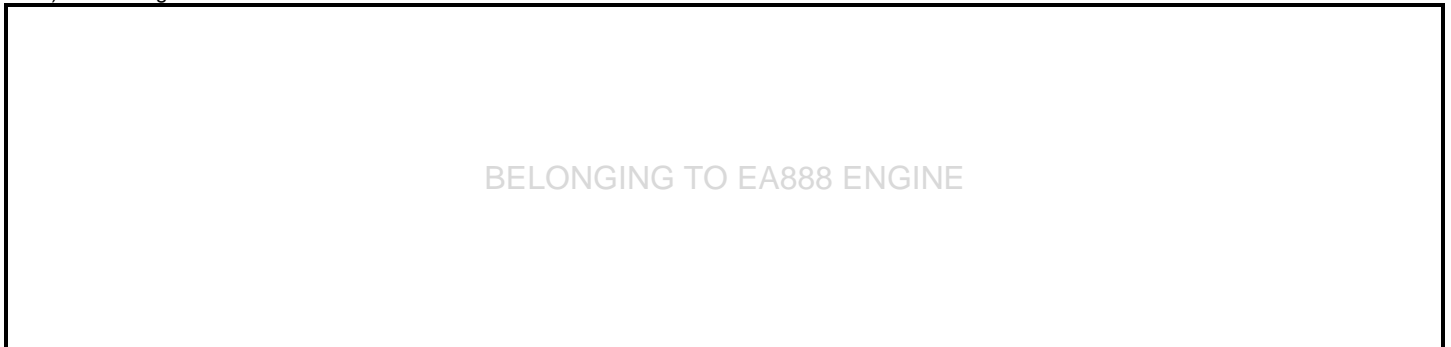

III-D1) Piston pin



III-D2) Minimum compression height

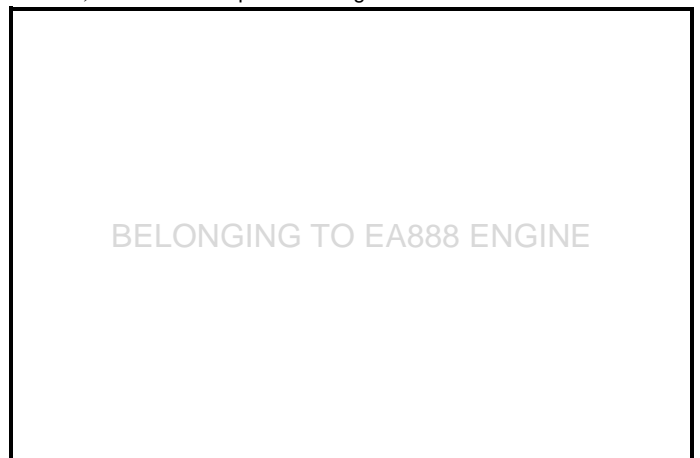





# REAL FEDERACIÓN ESPAÑOLA DE AUTOMOVILISMO

Certification N°

TCN2 - C - 001

Make: **SEAT SPORT**

Model: **SEAT Leon Cup Racer V1 / DSG**



REAL FEDERACIÓN ESPAÑOLA DE AUTOMOVILISMO Extension N°  
Departamento Técnico  
Technical Department

## 318. CONNECTING ROD BELONGING TO EA888 ENGINE

- |  |                   |
|--|-------------------|
| a) Material  | b) Big end type   |
| c) Interior diameter of the big end (without shell bearings) | +0.1 mm           |
| d) Length between axes ± 0.1 mm                              | e) Minimum weight |

C5-1) Connecting rod from ¾ on big end side

C5-2) Connecting rod from ¾ rear on small end side

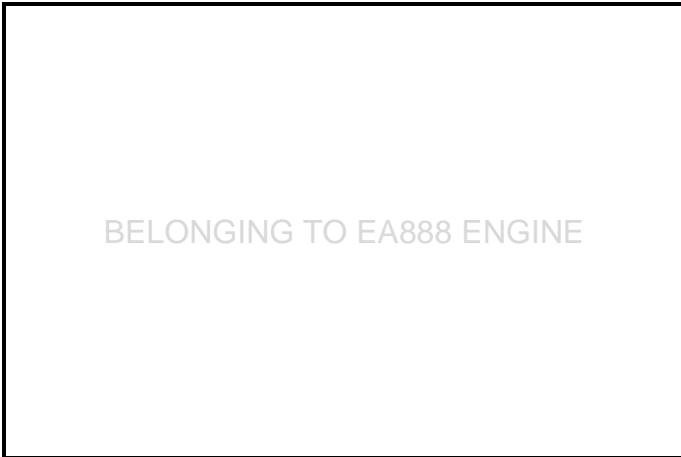

## 319. CRANKSHAFT BELONGING TO EA888 ENGINE

- |                                      |             |
|--------------------------------------|-------------|
| a) Type of manufacture               | b) Material |
| c) Manufacturing process:            |             |
| f) Diameter of bearings              | -0.1 mm     |
| g) Bearing caps material             |             |
| h) Minimum weight of bare crankshaft |             |
| i) Maximum diameter of crank pins    | mm          |
| j) Bearings: Width:                  | mm          |

C6-1) Crankshaft from ¾ front

C6-2) Crankshaft from ¾ rear



## C6-3) Alternative crankshaft bearings

**320. FLYWHEEL BELONGING TO EA888 ENGINE**

b) Weight	<b>11380</b>	± 500g
c) External diameter of the starter ring	<b>281.6</b>	± 3 mm
d) Number of teeth of the starter ring	<b>129</b>	
e) Thickness of the starter ring	<b>13 mm</b>	

## C7-1) Flywheel from ¼ front



## C7-2) Flywheel from ¼ rear

**321. CYLINDERHEAD BELONGING TO EA888 ENGINE**

b) Material		
c) Minimum height with / without gasket		mm ±0.1mm
d) Where measured		
e) Angle between intake valve and cylinder head gasket plane		deg±30´
f) Angle between exhaust valve and cylinder head gasket plane		deg±30´
g) Minimum volume of a combustion chamber		cm3
h) Minimum weight	g	With camshaft bearings caps, fixing studs (bearings caps, cylinder head cover, manifolds)



# REAL FEDERACIÓN ESPAÑOLA DE AUTOMOVILISMO

Certification N°

TCN2 - C - 001

Make: **SEAT SPORT**

Model: **SEAT Leon Cup Racer V1 / DSG**



REAL FEDERACIÓN ESPAÑOLA DE AUTOMOVILISMO Extension N°  
Departamento Técnico  
Technical Department

C8-1) Bare cylinder head seen from top (camshaft side)

C8-2) Bare cylinder head seen from underneath (chamber side)

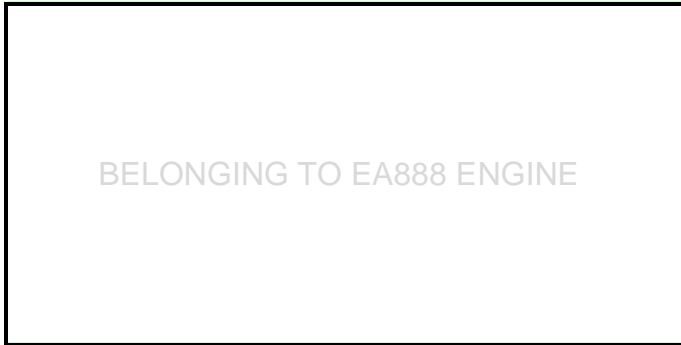

C8-3) Bare cylinder head seen from intake side

C8-4) Bare cylinder head seen from exhaust side

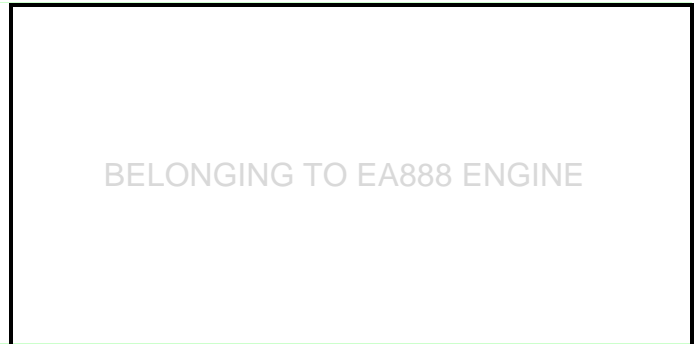

C8-5) Bare cylinder head seen from timing side

C8-6) Bare cylinder head seen from flywheel side

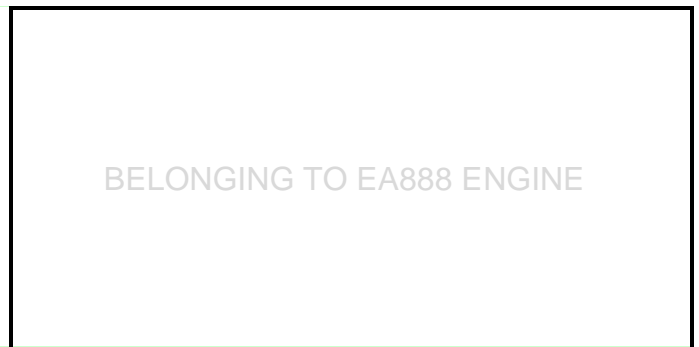

C8-7) Combustion chamber



## INTAKE

Drawings of cylinder head ports - tolerances on dimensions

III-K1) Cylinder head, manifold side

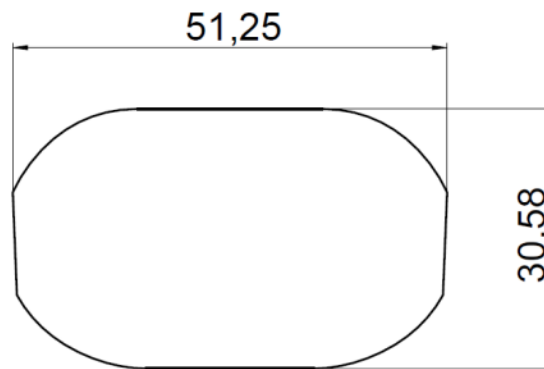
Dimensions in mm, tolerances  $\pm 1\%$ 

## EXHAUST

Drawings of cylinder head ports - tolerances on dimensions

III-L1) Cylinder head, manifold side

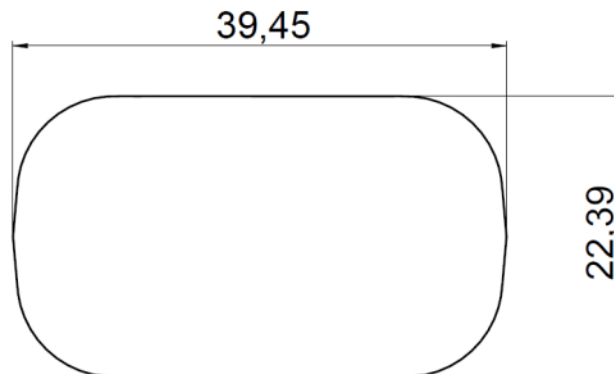
Dimensions in mm, tolerances  $\pm 1\%$

## 322. CYLINDERHEAD GASKET

- a) Thickness of new / tightened cylinder head gasket **0.9mm** ± 0.1 mm

C8-8) Cylinder head gasket from above

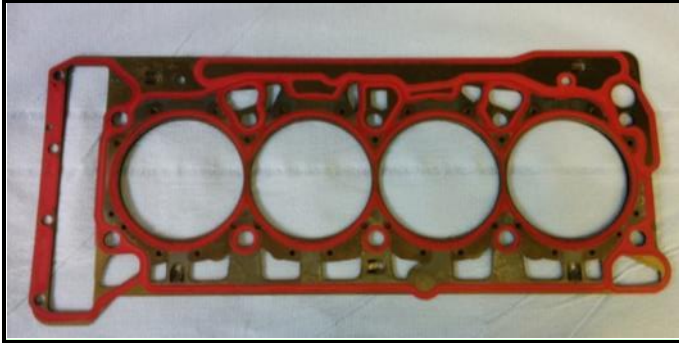

C8-9) Cylinder head gasket from below

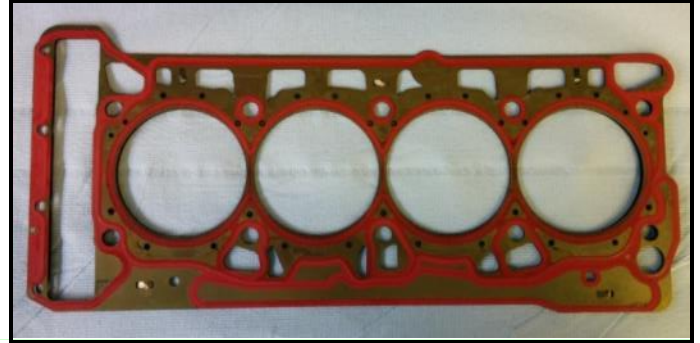

## 324. FUEL FEED BY INJECTION - ELECTRONICS

- a) Make and type **CONTINENTAL**  
 b) ECU Model **SIMOS 18.1**  
 f) Injector's make f1) OEM Origin: **VW Group** b1) Software: **5F6906259\_\_0001** b2) Check number: **72 DC 3A 5C**  
 g) List of engine control system sensors f2) Identification: -

- |  |   |
|--|---|
| <b><u>C1</u></b> THROTTLE PEDAL POSITION             | <b><u>C10</u></b> INTAKE MANIFOLD AIR PRESSURE AND TEMP |
| <b><u>C2</u></b> KNOCKING SENSOR                     | <b><u>C11</u></b> FUEL PRESSURE (HP)                    |
| <b><u>C3</u></b> FUEL PRESSURE (LP)                  | <b><u>C12</u></b> BOOST PRESSURE                        |
| <b><u>C4</u></b> HALL SENSOR (2)                     | <b><u>C13</u></b> LAMBDA PROBE                          |
| <b><u>C5</u></b> WATER TEMPERATURE                   | <b><u>C14</u></b> OIL ENGINE PRESSURE (3)               |
| <b><u>C6</u></b> WATER TEMPERATURE (AFTER RADIATOR)  | <b><u>C15</u></b> FUEL LEVEL SENSOR (2)                 |
| <b><u>C7</u></b> ENGINE SPEED                        | <b><u>C16</u></b>                                       |
| <b><u>C8</u></b> ENGINE OIL LEVEL AND TEMP           | <b><u>C17</u></b>                                       |
| <b><u>C9</u></b> INTAKE MANIFOLD FLAPS POTENTIOMETER | <b><u>C18</u></b>                                       |

- h) List of engine control system actuators

- |   |  |
|---|--|
| <b><u>A1</u></b> ELECTRIC THROTTLE                | <b><u>A9</u></b> OIL PRESSURE REGULATION VALVE   |
| <b><u>A2</u></b> COILS (4)                        | <b><u>A10</u></b> WASTE GATE                     |
| <b><u>A3</u></b> SPARK PLUGS (4)                  | <b><u>A11</u></b> COOLING PISTON VALVE           |
| <b><u>A4</u></b> COMBUSTION CHAMBER INJECTORS (4) | <b><u>A12</u></b> CAM ADJUSTMENT ACTUATOR (8)    |
| <b><u>A5</u></b> INTAKE MANIFOLD INJECTORS (4)    | <b><u>A13</u></b> INTAKE MANIFOLD THROTTLE VALVE |
| <b><u>A6</u></b> GEARBOX COOLING VALVE            | <b><u>A14</u></b> FUEL PUMP                      |
| <b><u>A7</u></b> TURBO CHARGER BYPASS VALVE       | <b><u>A15</u></b> ENGINE WARMING VALVE           |
| <b><u>A8</u></b> VARIABLE DISTRIBUTION VALVES (2) | <b><u>A16</u></b> ADITIONAL WATER PUMP           |

## C9-1) Engine control system sensors

 <b>C1</b>	 <b>C2</b>	 <b>C3</b>	 <b>C4</b>
 <b>C5</b>	 <b>C6</b>	 <b>C7</b>	 <b>C8</b>
 <b>C9</b>	 <b>C10</b>	 <b>C11</b>	 <b>C12</b>
 <b>C13</b>	 <b>C14</b>	 <b>C15</b>	N/A <b>C16</b>
N/A <b>C17</b>	N/A <b>C18</b>		

C9-2) Engine control system actuators

			
<b>A1</b>	<b>A2</b>	<b>A3</b>	<b>A4</b>
			
<b>A5</b>	<b>A6</b>	<b>A7</b>	<b>A8</b>
			
<b>A9</b>	<b>A10</b>	<b>A11</b>	<b>A12</b>
			
<b>A13</b>	<b>A14</b>	<b>A15</b>	<b>A16</b>
			
<b>ENGINE ECU</b>		<b>POWER UNIT</b>	



# REAL FEDERACIÓN ESPAÑOLA DE AUTOMOVILISMO

Certification N°

TCN2 - C - 001

Make: **SEAT SPORT**

Model: **SEAT Leon Cup Racer V1 / DSG**



REAL FEDERACIÓN ESPAÑOLA DE AUTOMOVILISMO Extension N°

Departamento Técnico  
Technical Department

N/A

INJECTOR DRIVER

N/A

HP FUEL PUMP DRIVER



## III-1) LOCATION OF SENSORS AND ACTUATORS

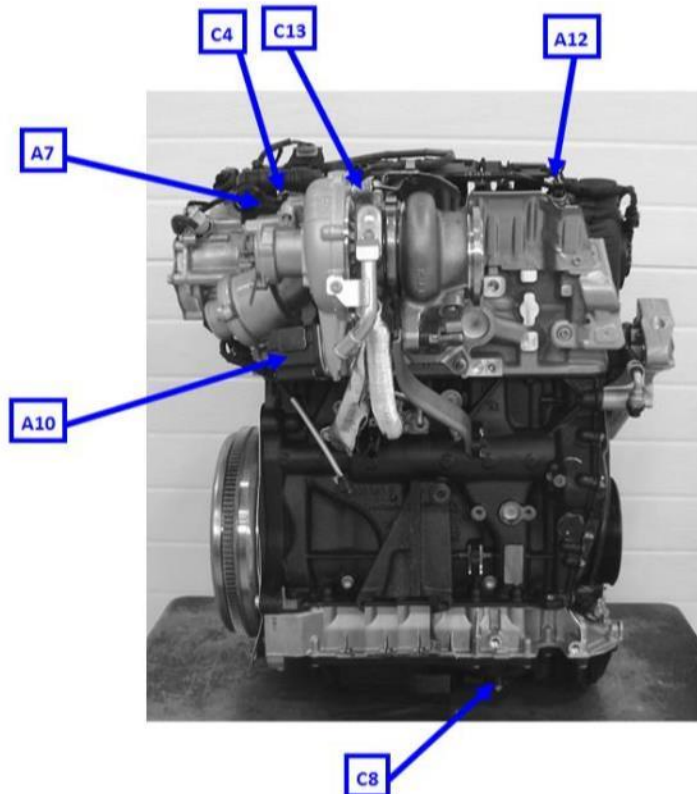
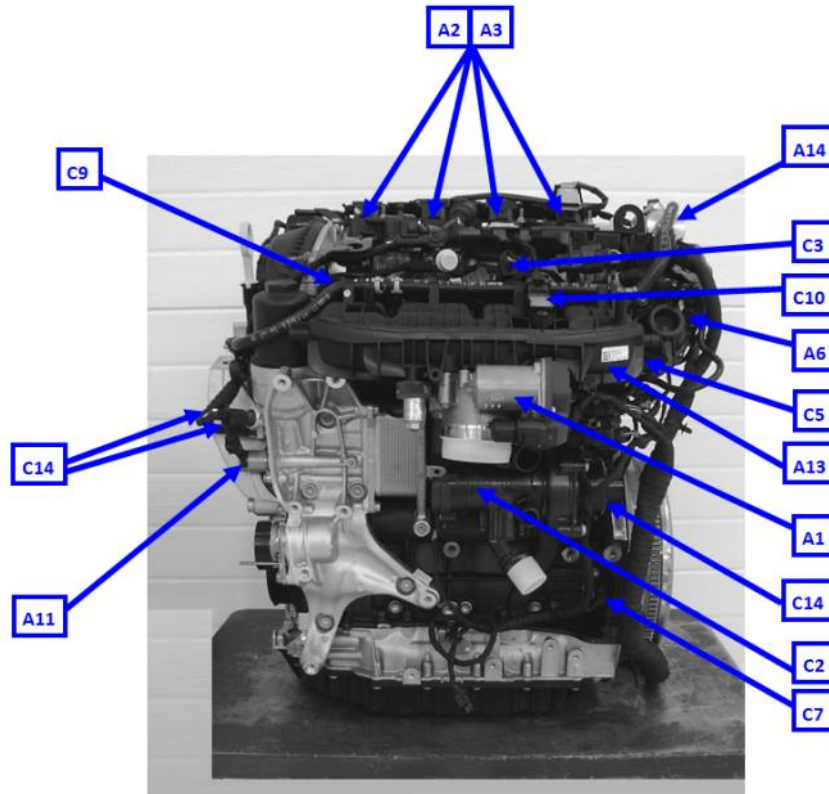

## III-2) FUEL INJECTION SCHEME

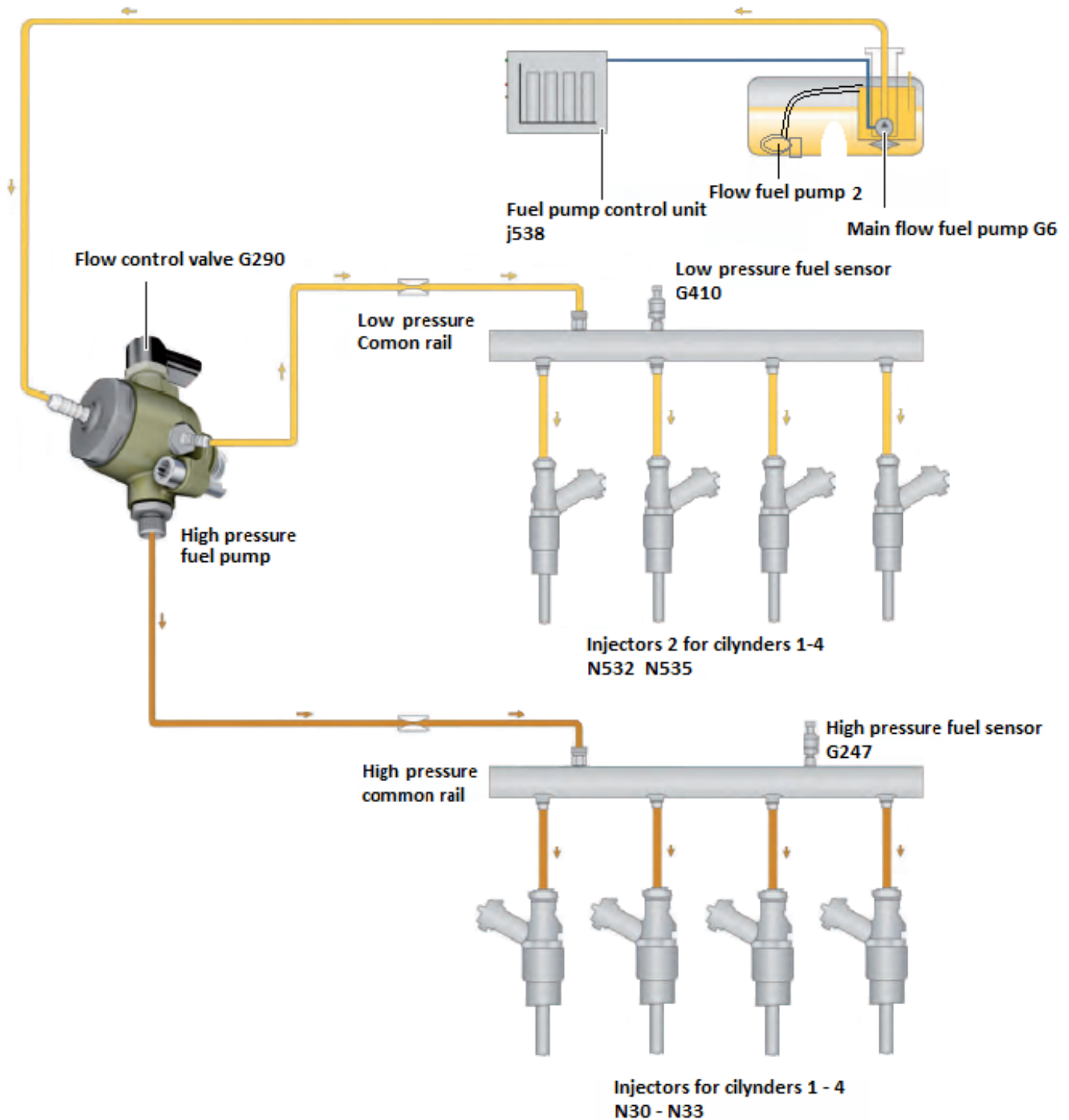

## SCRUTINEERING DATA LOGGING SYSTEM

i) List of FIA data logging system sensors

<b>DL0</b>	<b>Boost pressure</b>	<b>MEMOTEC</b>	
<b>DL1</b>	<b>Engine speed</b>	<b>OEM VW GROUP</b>	
<b>DL2</b>	<b>Front wheel speed</b>	<b>OEM VW GROUP</b>	<b>LOOM SEAT SPORT</b>
<b>DL3</b>	<b>Rear wheel speed</b>	<b>OEM VW GROUP</b>	
<b>DL4</b>	<b>Lambda sensor</b>	<b>OEM VW GROUP</b>	

C9-2) Scrutineering data logging system



**DATA LOGGING UNIT IN ITS LOCATION**



**BOOST PRESSURE SENSOR IN LOCATION**



**LAMBDA SENSOR IN LOCATION**



**WIRE LOOM DISMOUNTED**

1. Data logger AIM EVO 4
2. GPS antenna
3. USB cable
4. Connection cable CAN
5. Extension cable Memory Key
6. Connection cable 12V
7. Boost/Manifold pressure sensor



ENGINE SPEED SENSOR IN ITS LOCATION



FRONT WHEEL SPEED SENSOR IN ITS LOCATION



REAR WHEEL SPEED SENSOR IN ITS LOCATION

## III-I2) SCRUTINEERING DATA LOGGING SYSTEM; WIRE LOOM DRAWING

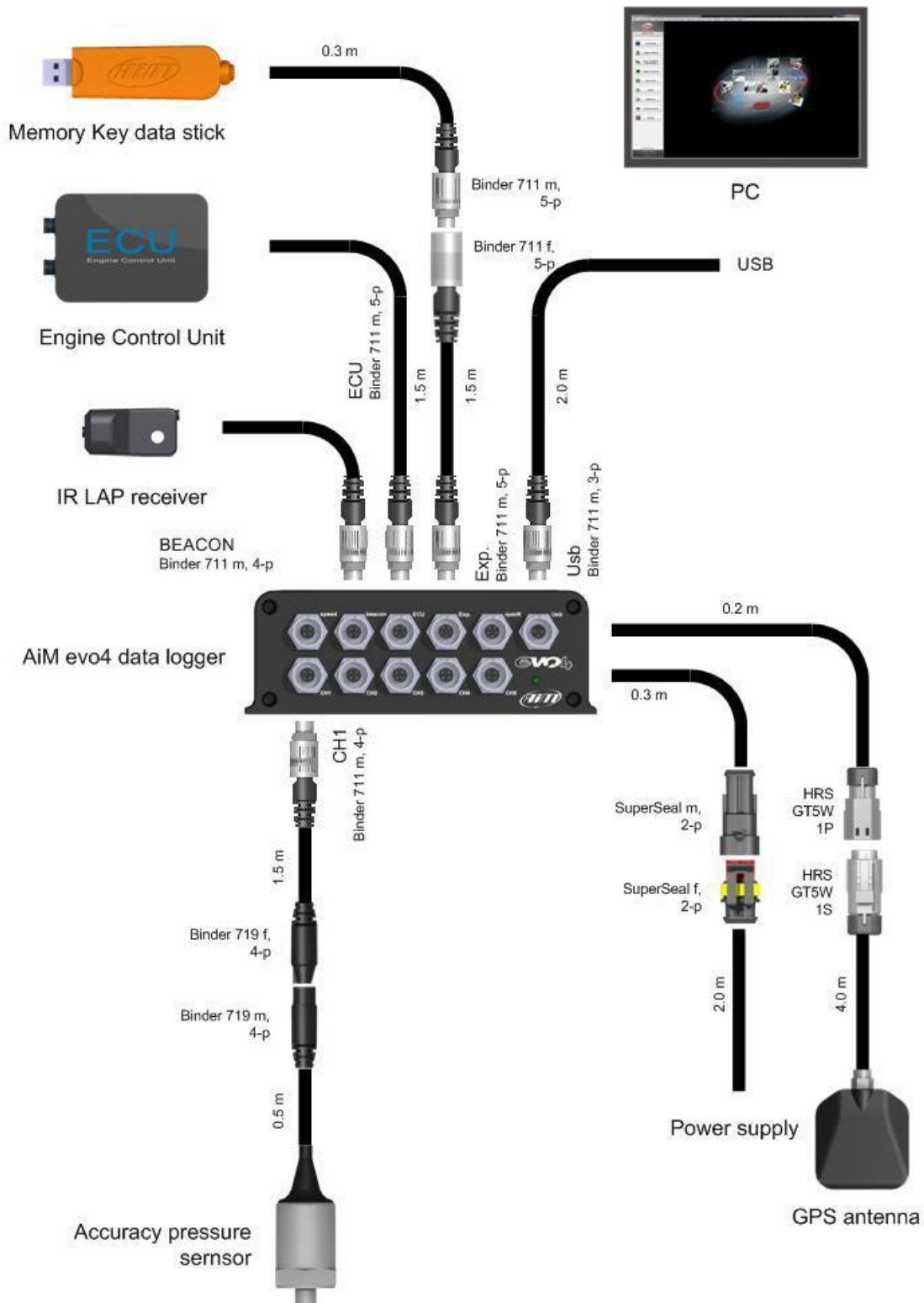



# REAL FEDERACIÓN ESPAÑOLA DE AUTOMOVILISMO

Certification N°

TCN2 – C – 001

Make: **SEAT SPORT**

Model: **SEAT Leon Cup Racer V1 / DSG**



REAL FEDERACIÓN ESPAÑOLA DE AUTOMOVILISMO Extension N°  
Departamento Técnico  
Technical Department

## 325. CAMSHAFT BELONGING TO EA888 ENGINE

- c) Drive system
- e) Diameter of bearings
- g) Cam dimensions

± 0.1 mm

	Intake	Exhaust
A =	± 0.1 mm	± 0.1 mm
B =	± 0.1 mm	± 0.1 mm

The tolerances must be used with the same sign for A and B

- h) Minimum weight(s)

Intake:                      kg                      Exhaust:                      kg

## 326. TIMING BELONGING TO EA888 ENGINE

- a) Theoretical clearance                      Intake                      mm                      Exhaust                      mm
- b) Cam lift in mm (dismounted camshaft)

INTAKE				EXHAUST			
Rotation angle in degrees	Lift in mm (± 0.05 mm)	Rotation angle in degrees	Lift in mm (± 0.05 mm)	Rotation angle in degrees	Lift in mm (± 0.05 mm)	Rotation angle in degrees	Lift in mm (± 0.05 mm)
0				0			
- 5		+ 5		- 5		+ 5	
- 10		+ 10		- 10		+ 10	
- 15		+ 15		- 15		+ 15	
- 30		+ 30		- 30		+ 30	
- 45		+ 45		- 45		+ 45	
- 60		+ 60		- 60		+ 60	
- 75		+ 75		- 75		+ 75	
- 90		+ 90		- 90		+ 90	
- 105		+ 105		- 105		+ 105	
- 120		+ 120		- 120		+ 120	
- 135		+ 135		- 135		+ 135	
- 150		+ 150		- 150		+ 150	

A shift of ± 2 degrees of the whole measurement is accepted

- c) Maximum valve lift

Intake	Exhaust
± 0.2 mm	± 0.2 mm

with clearance according to Art. 326a



# REAL FEDERACIÓN ESPAÑOLA DE AUTOMOVILISMO

Certification N°

TCN2 – C – 001

Make: **SEAT SPORT**

Model: **SEAT Leon Cup Racer V1 / DSG**



REAL FEDERACIÓN ESPAÑOLA DE AUTOMOVILISMO Extension N°  
Departamento Técnico  
Technical Department

C10-1) Camshaft - dismounted



C10-2) Camshaft - dismounted



C10-5) Rocker arm – dismounted

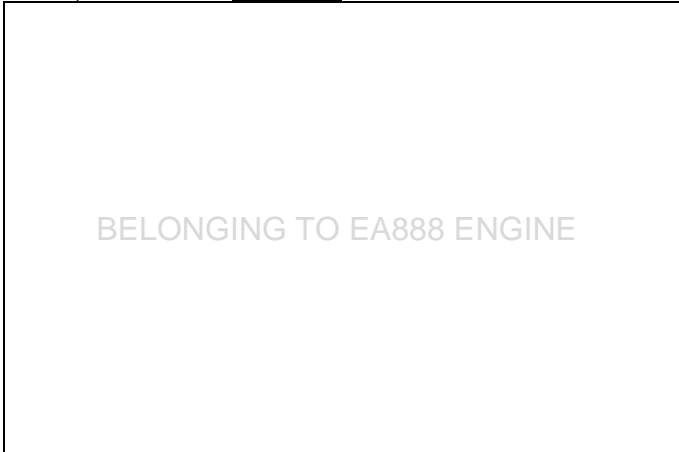

III-J2) Rocker arm – typical dimensions

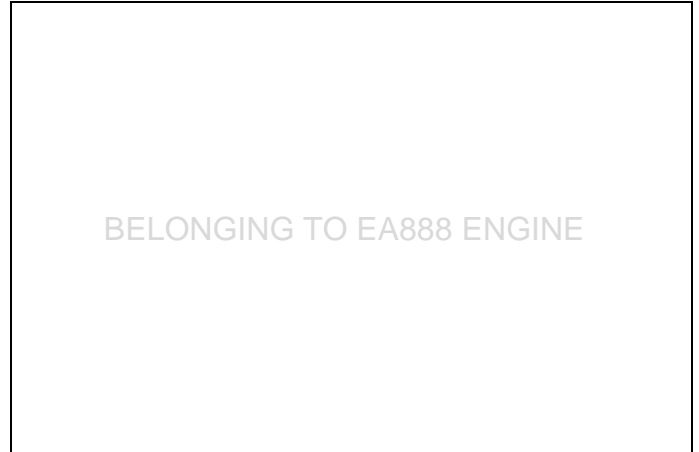

C10-6) Tappet – dismounted

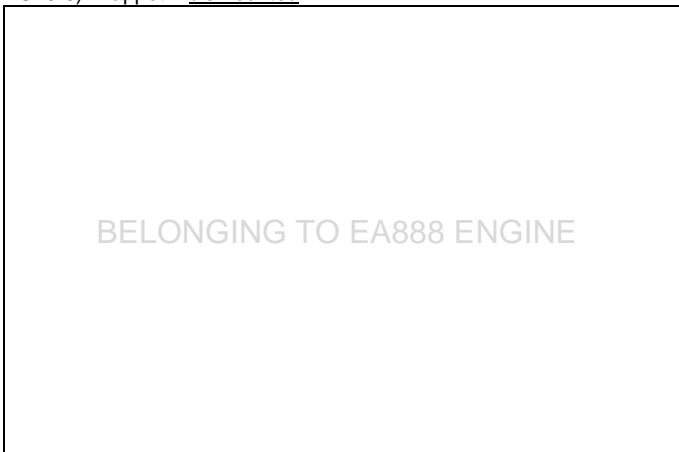

III-J3) Tappet – typical dimensions



C10-7) Timing belt or chain - dismounted



Pitch:  
Number of teeth:  
Nominal length:  
Width:

## 327. INTAKE

- a) Air filter housing
- b) Air filter element

Make: **BMC**

Identification: **ACCDA100-220A**

Make: **BMC**

Identification: **SPCDA100-200S-6L**

C11-1) Intake manifold - dismounted



C11-2) Air filter and its housing - dismounted



C11-3) Throttle unit - dismounted



C11-4) Throttle unit - dismounted



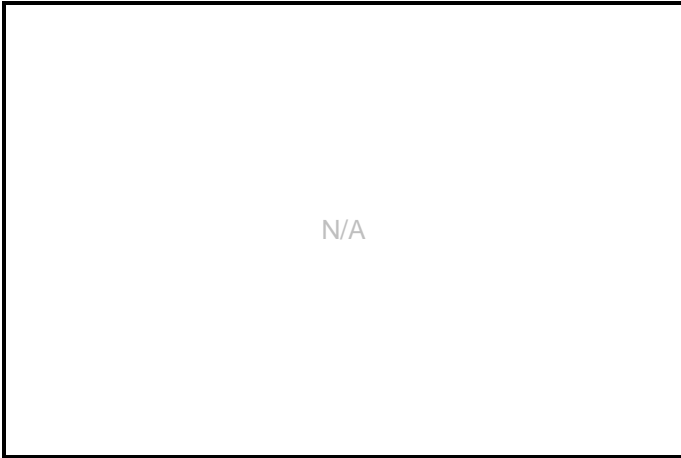
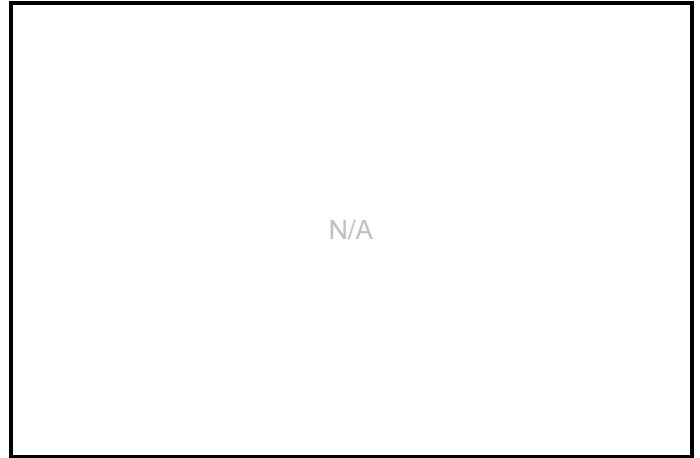

Make: **SEAT SPORT**Model: **SEAT Leon Cup Racer V1 / DSG**REAL FEDERACIÓN ESPAÑOLA  
DE AUTOMOVILISMO Extension N°  
Departamento Técnico  
Technical DepartmentC11-6) Pressure relief valve - dismountedC11-7) Pressure relief valve - Mounted on manifoldC11-8) Air ducts - dismountedC11-9) Intake manifold & Air ducts - in location

III-K4) Section drawing of the throttle-unit

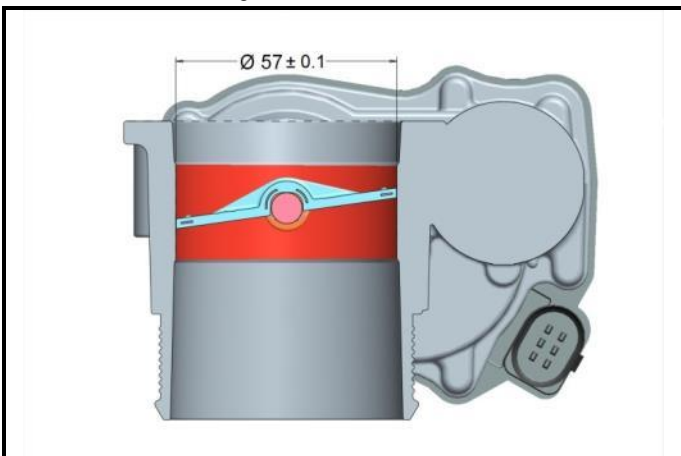

## INTAKE

### Drawings of manifold ports - tolerances on dimensions

#### III-K2) Manifold, cylinder head side

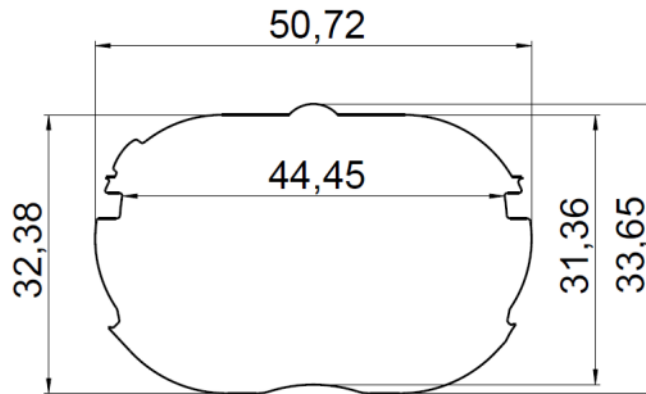

Dimensions in mm, tolerances  $\pm 1\%$

#### III-K3) Manifold cross section

N/A

**328. EXHAUST**

a) Material of manifold	<b>Steel</b>		
b) Number of manifold elements	<b>Integrated into the cylinderhead</b>		
c) Internal dimensions of manifold exit		± 0.2 mm	
c1) Minimum thickness of tubes		mm	
e) Maximum diameter of the valve		mm	e1) Angle of valve head                      deg ± 30 min
f) Diameter of valve stem in guide		-0.2 mm	
g) Valve length		± 1.5 mm	
h) Catalyst			

Homologation: **FIA WRC 1279/10 PE**

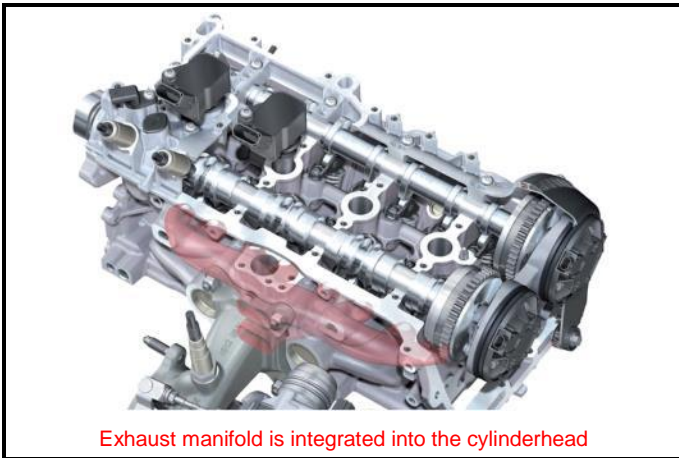
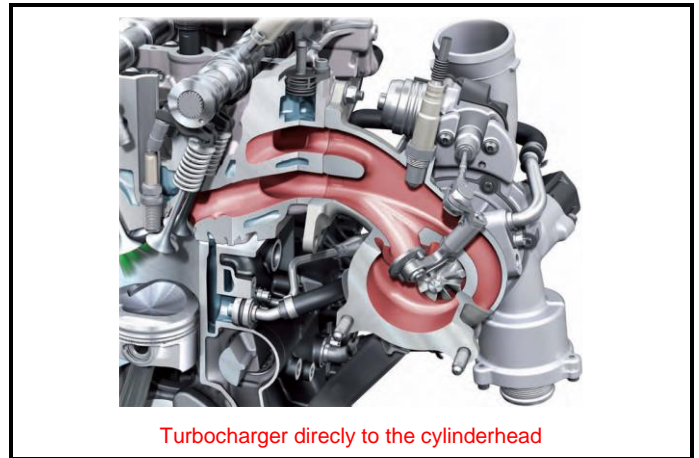
 C12-1) Exhaust manifold - dismounted

 C12-2) Exhaust manifold - dismounted

## EXHAUST

### Drawings of manifold ports - tolerances on dimensions

**III-L2) Manifold, cylinder head side**

N/A



# REAL FEDERACIÓN ESPAÑOLA DE AUTOMOVILISMO

Certification N°

TCN2 - C - 001

Make: **SEAT SPORT**

Model: **SEAT Leon Cup Racer V1 / DSG**



REAL FEDERACIÓN ESPAÑOLA DE AUTOMOVILISMO Extension N°

Departamento Técnico  
Technical Department

## III-L3) EXHAUST SYSTEM

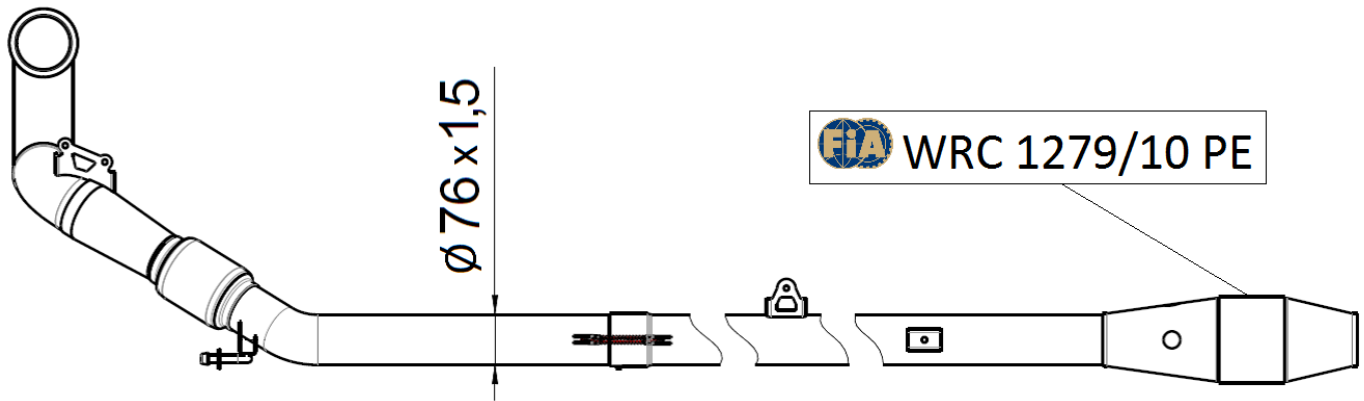

## 331. COOLING SYSTEM

- a) Water Radiator: **One radiator at the front**
- c) Type of the water pump: **Mechanical / Serial pump**
- d) Type of the Thermostat: **Mechanical commanded electronically**

Origin: **OEM VW GROUP** Identification:

Identification:

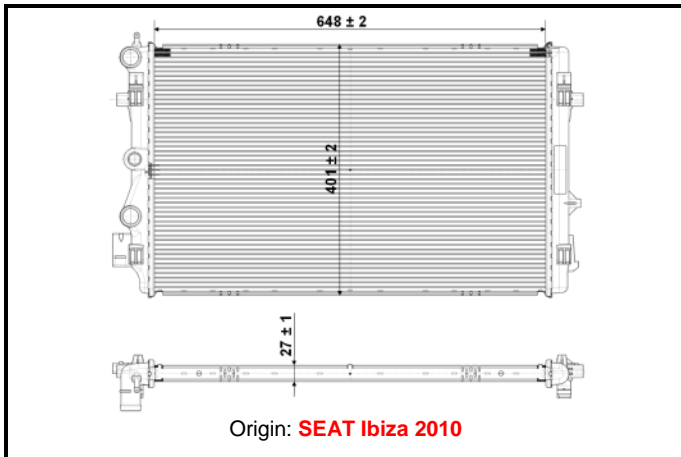
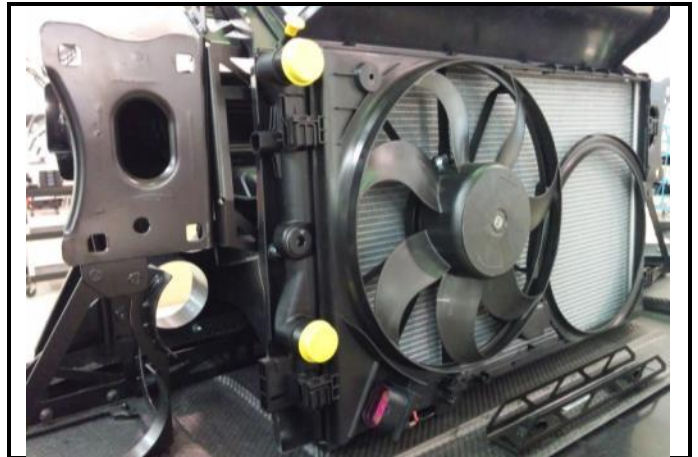
C13-1) Water radiator dismounted with hoses and pipesC13-2) Water radiator in location

C13-3) Water pump - dismounted

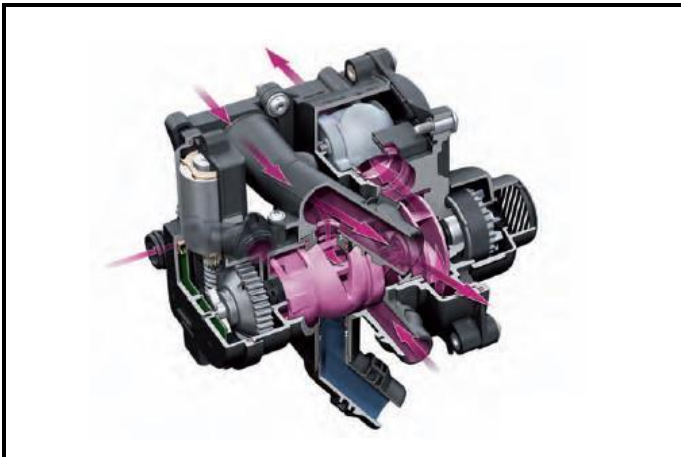

C13-4) Water pump mounted on engine

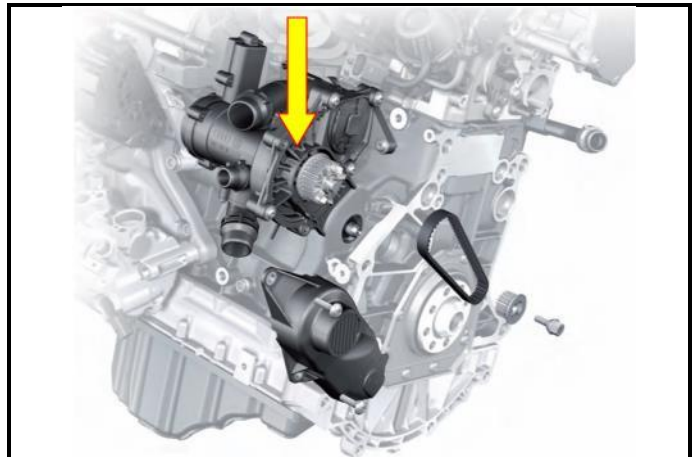

C13-5) Turbine wheel of water pump

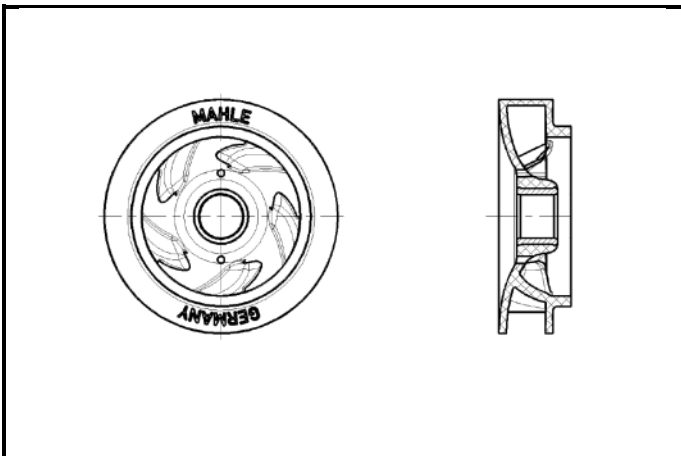

C13-6) Water cooler air ducts - dismounted





# REAL FEDERACIÓN ESPAÑOLA DE AUTOMOVILISMO

Certification N°

TCN2 - C - 001

Make: SEAT SPORT

Model: SEAT Leon Cup Racer V1 / DSG



REAL FEDERACIÓN ESPAÑOLA DE AUTOMOVILISMO Extension N°  
Departamento Técnico  
Technical Department

C13-7) Cooling system

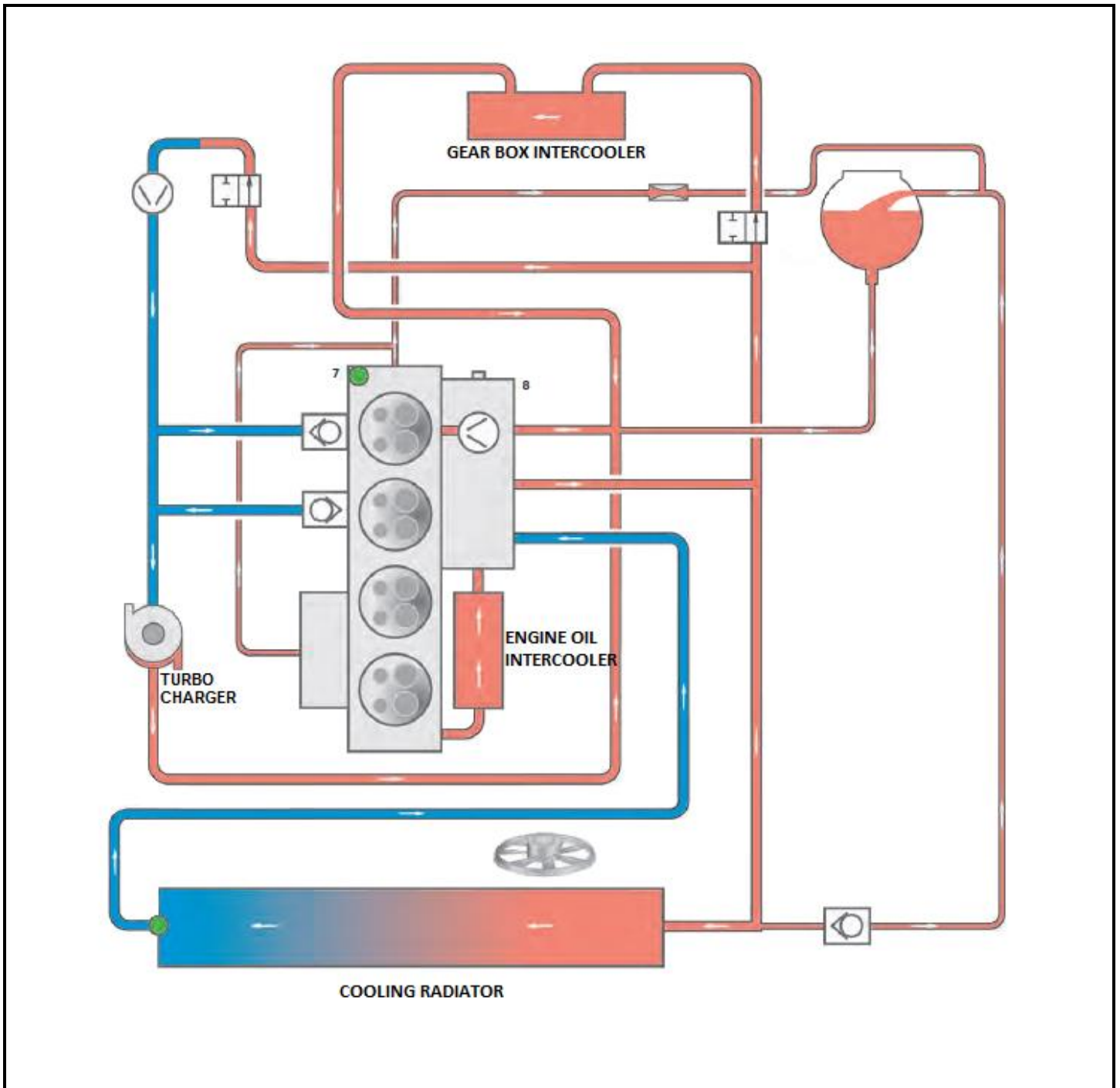

### 332. COOLING FAN(S)

- |                   |                    |                       |            |    |
|-------------------|--------------------|-----------------------|------------|----|
| a) Number         | <b>1</b>           | b) Fan max. diameter: | <b>363</b> | mm |
| c) Fan's material | <b>Plastic</b>     | d) Number of blades   | <b>7</b>   |    |
| e) Type of drive  | <b>ECU control</b> | f) Automatic cut off  | <b>Yes</b> |    |

C13-7) Electric & mechanic fans dismantled

C13-8) Electric & mechanic fans in location

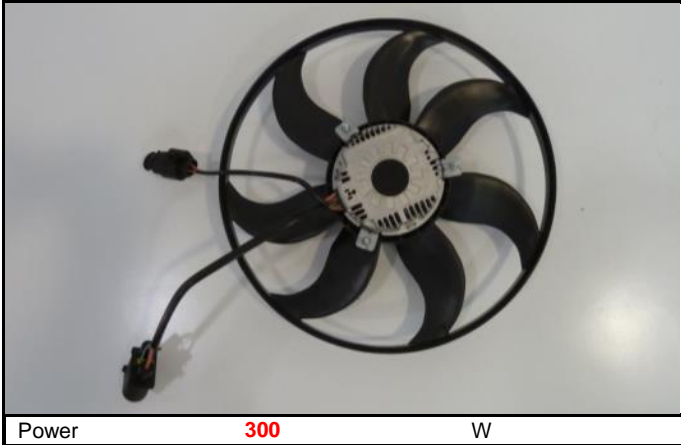

Power **300** W

### 333. LUBRICATION SYSTEM

- |                          |                |              |            |            |
|--------------------------|----------------|--------------|------------|------------|
| a1) Material of oil sump | <b>Plastic</b> | a2) Capacity | <b>6.5</b> | ±0.5 litre |
|--------------------------|----------------|--------------|------------|------------|

C14-1) Oil sump with bafflers, deflectors and spacer – dismounted (exploded view)

C14-2) Oil sump with bafflers, deflectors and spacer – dismounted (exploded view)



C14-3) Oil pump - dismounted

C14-3b) Oil pump – dismounted

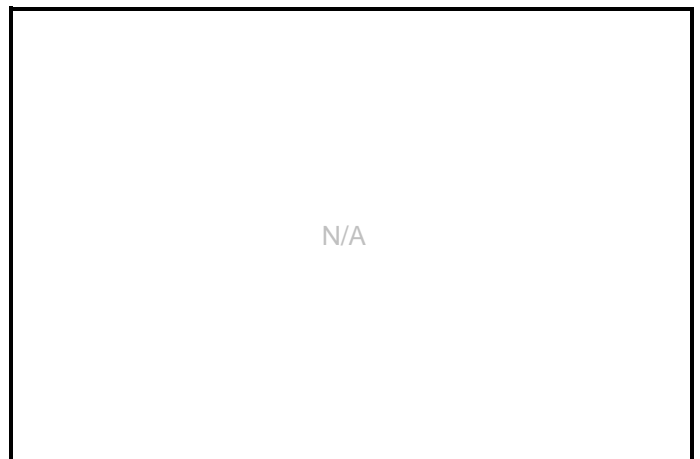

Make: **SEAT SPORT**

Model: **SEAT Leon Cup Racer V1 / DSG**



REAL FEDERACIÓN ESPAÑOLA DE AUTOMOVILISMO Extension N°

Departamento Técnico  
Technical Department

C14-4) Oil pump – mounted in its location

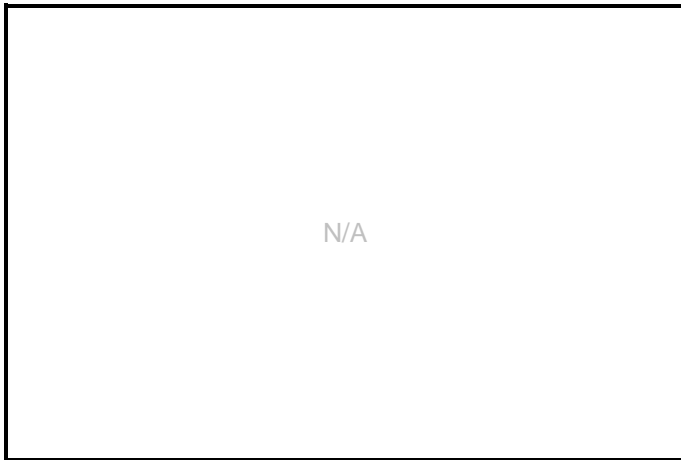

C14-7) Oil pressure accumulator - dismounted

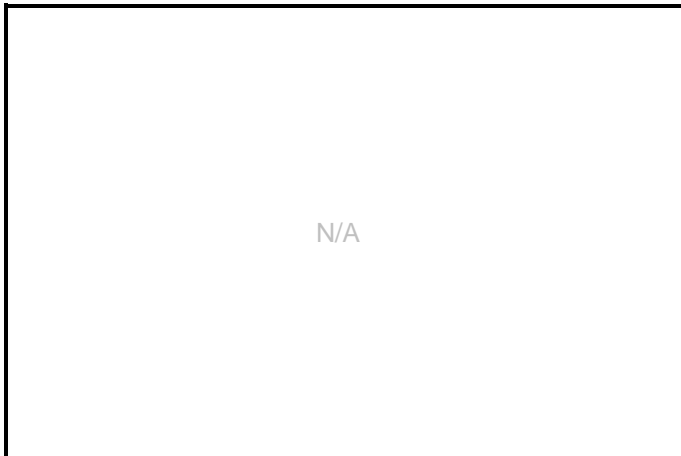

C14-8) Oil pressure accumulator – mounted in its location

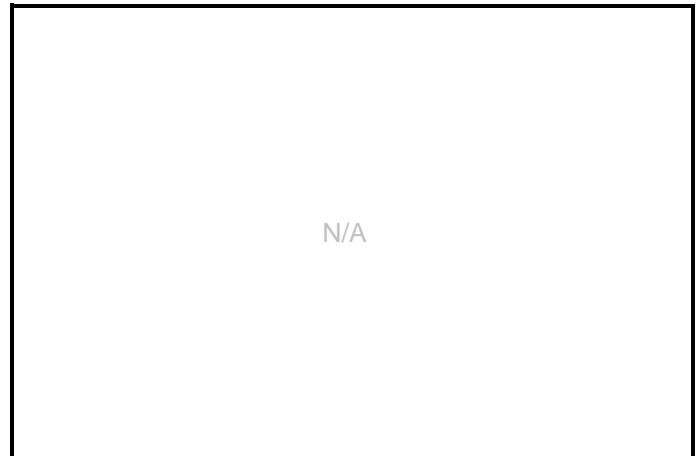

C14-9) Oil cooler with connections - dismounted

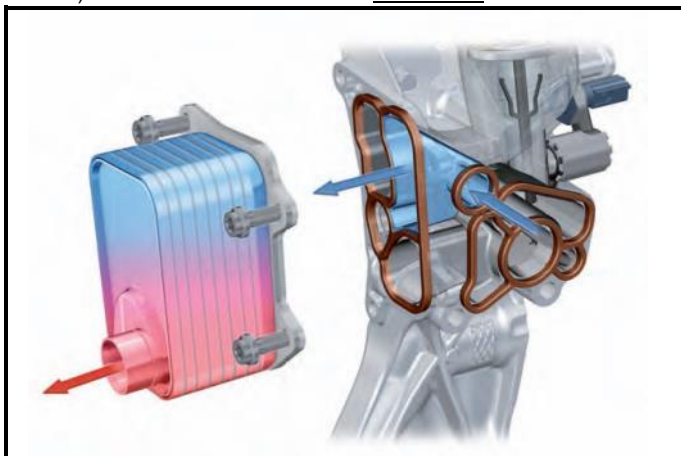

C14-10) Oil cooler – mounted in its location

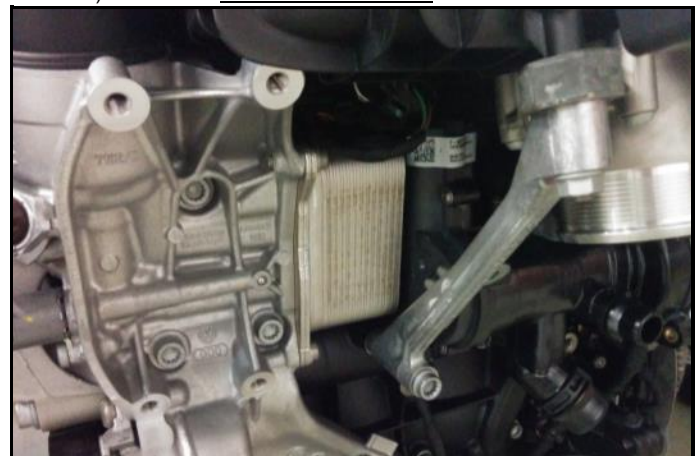



**334. TURBOCHARGING BELONGING TO EA888 ENGINE**

a) Make of turbocharger  
 a1) Restrictor position:

Identification:  
 Restrictor dia. 100%  
 Restrictor dia. 95%  
 Restrictor dia. 90%

Origin: **OEM VW GROUP**

.....mm -0.1 mm  
 .....mm -0.1 mm  
 .....mm -0.1 mm

c) Turbine wheel

c1) Material  
 c2) Number of blades  
 c4) Dimensions A, B, C, according to the sketch

A = ± 0.1 mm  
 B = ± 0.3 mm  
 C = ± 0.1 mm  
 D = ± 0.30 mm

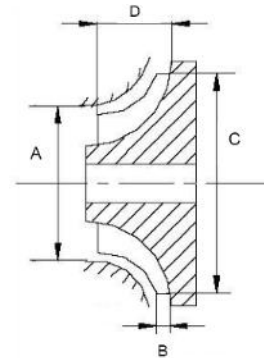

d) Impeller housing

d1) Number of air entries (mixture)  
 d2) Material

**Cast aluminium**

e) Impeller wheel

e1) Material  
 e2) Number of blades  
 e4) Dimensions A, B, C, according to the sketch

**Aluminium**

A = ± 0.1 mm  
 B = ± 0.1 mm  
 C = ± 0.2 mm  
 D = ± 0.1 mm

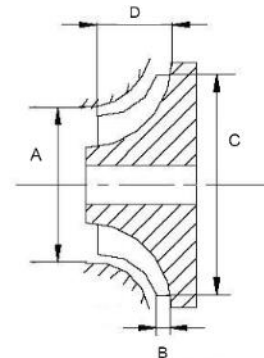

f) Pressure regulation

f1) Type of pressure adjustment  
 f2) Type of pressure adjustment

By-pass

Relief valve

Other



g) Exhaust system

g1) Internal dimensions of the possible pipes between manifold and turbocharger

± 2mm

i) Maximum absolute supercharging pressure

Mbar

h) Cooling of intake air

Type:

OEM origin:

Identification:

h3) Air inlet diameter

± 1mm

h4) Air outlet diameter

± 1mm

III-01) Exhaust gas inlet to the turbine housing

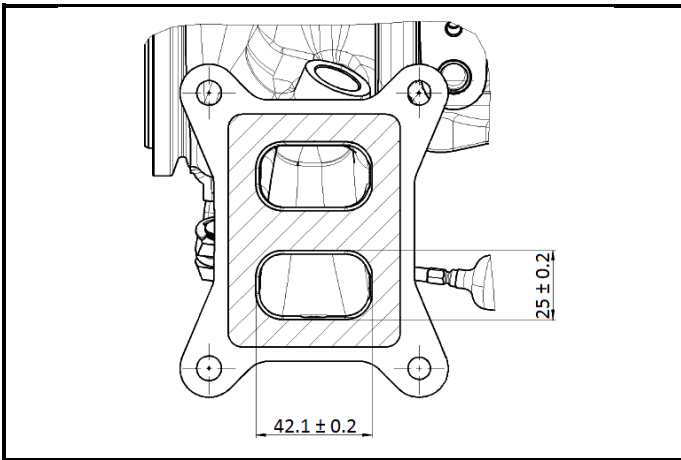

III-02) Exhaust gas outlet from the turbine housing

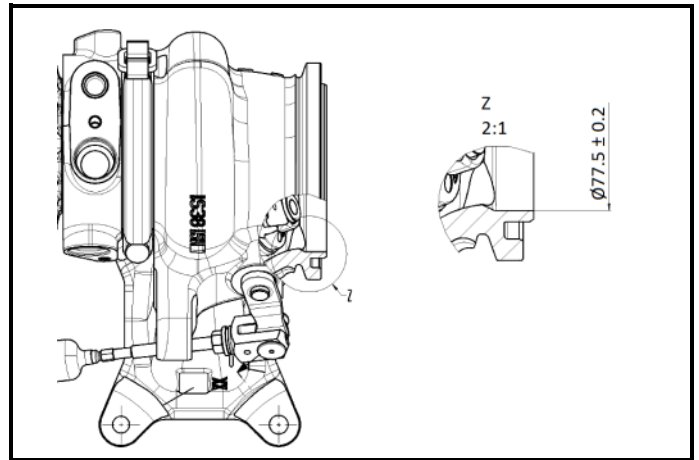

III-03) Air inlet to the compressor housing

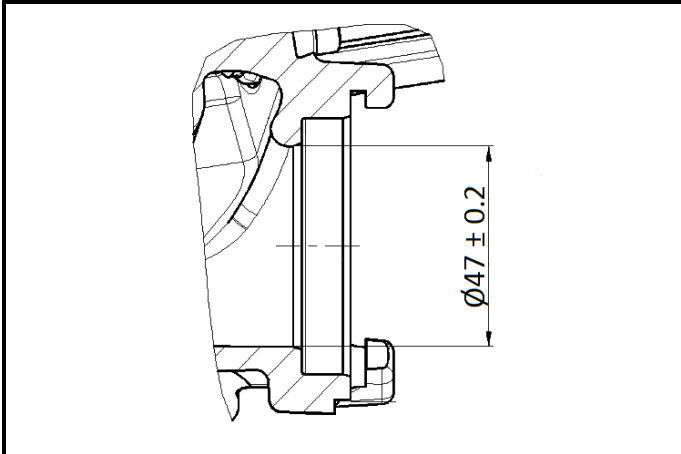

III-04) Air outlet from the compressor housing

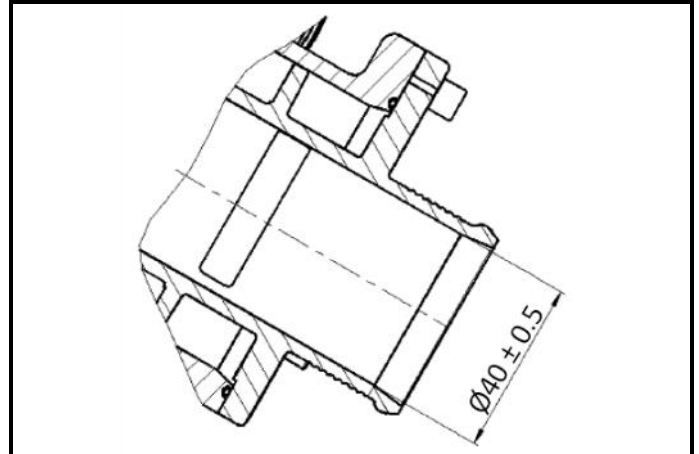

C15-1) Plan view of complete turbocharger unit



C15-2) Front view of complete turbocharger unitC15-3) Side view of complete turbocharger unit

C15-4) Valve and by-pass installation of turbocharger



C15-5) Exhaust system between manifold and turbocharger

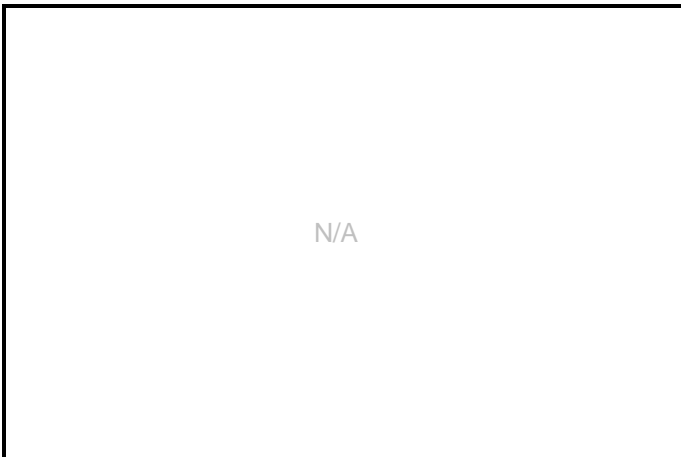

C15-6) Turbocharger unit with Air Restrictor

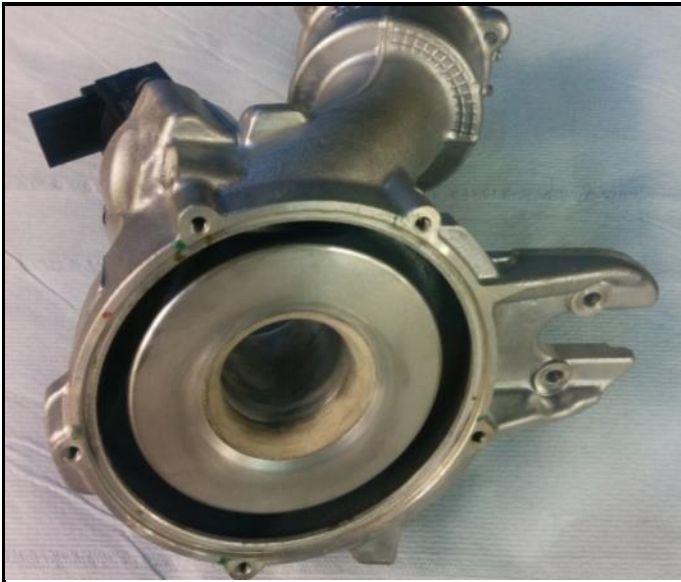
C15-7) Compression housing of turbocharger - dismountedC15-8) Turbine housing of turbocharger - dismounted

C15-9) Intercooler - dismounted



C15-10) Intercooler - mounted in its location with air ducts



III-05) Drawing of the intercooler with dimensions of core (Width x Height x Thickness)

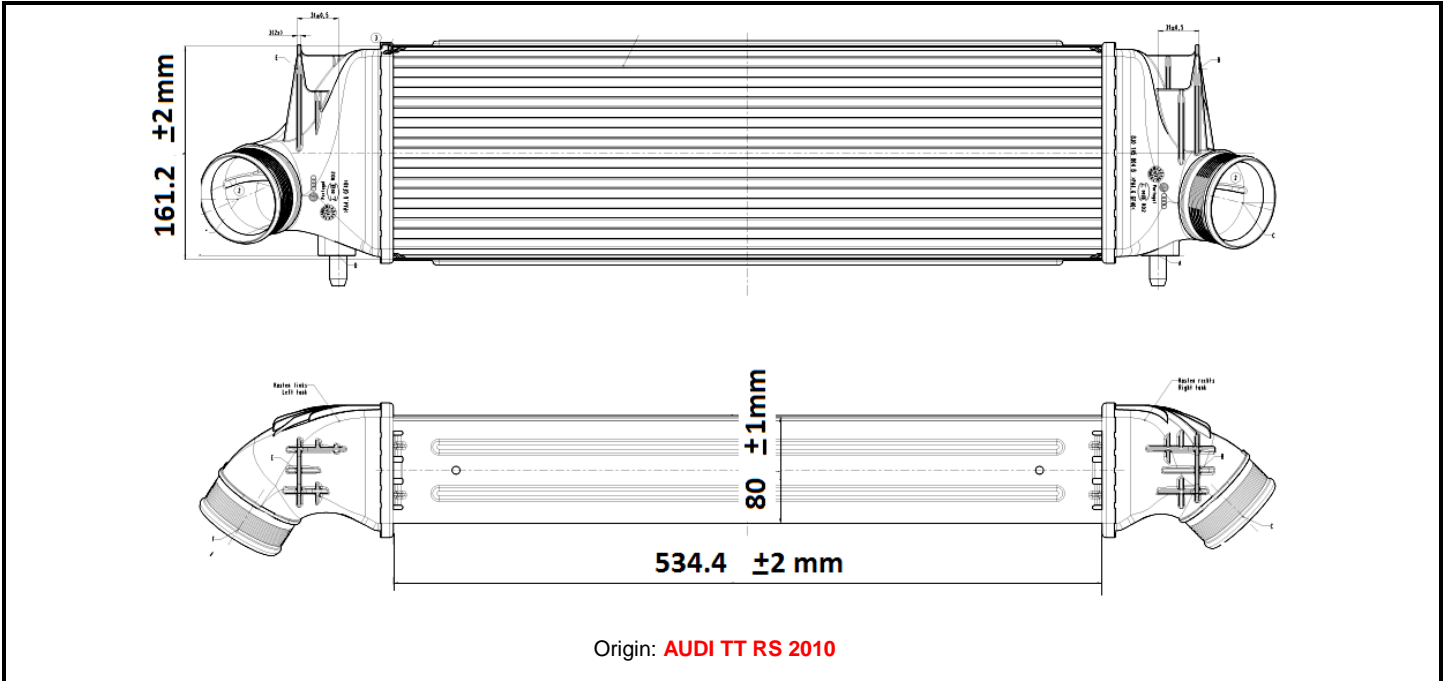

C15-10) Air injection system - dismounted

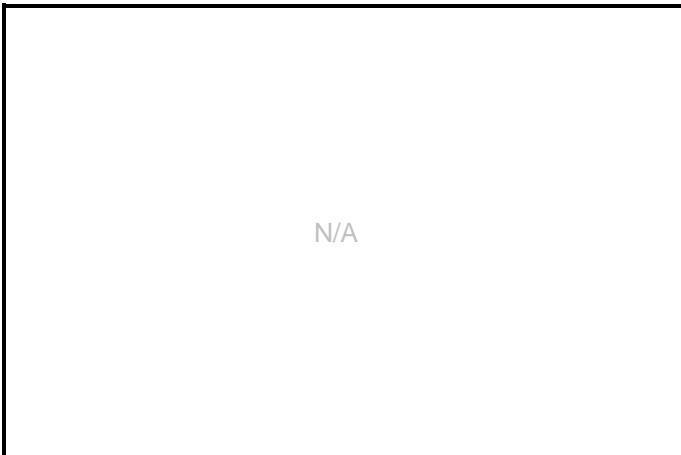

C15-11) Air injection system - mounted in its location

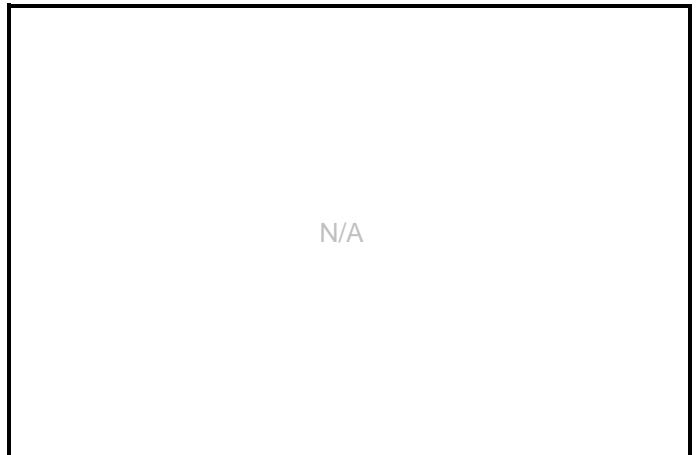

## III-06) DEVICE REGULATING THE TURBOCHARGER PRESSURE

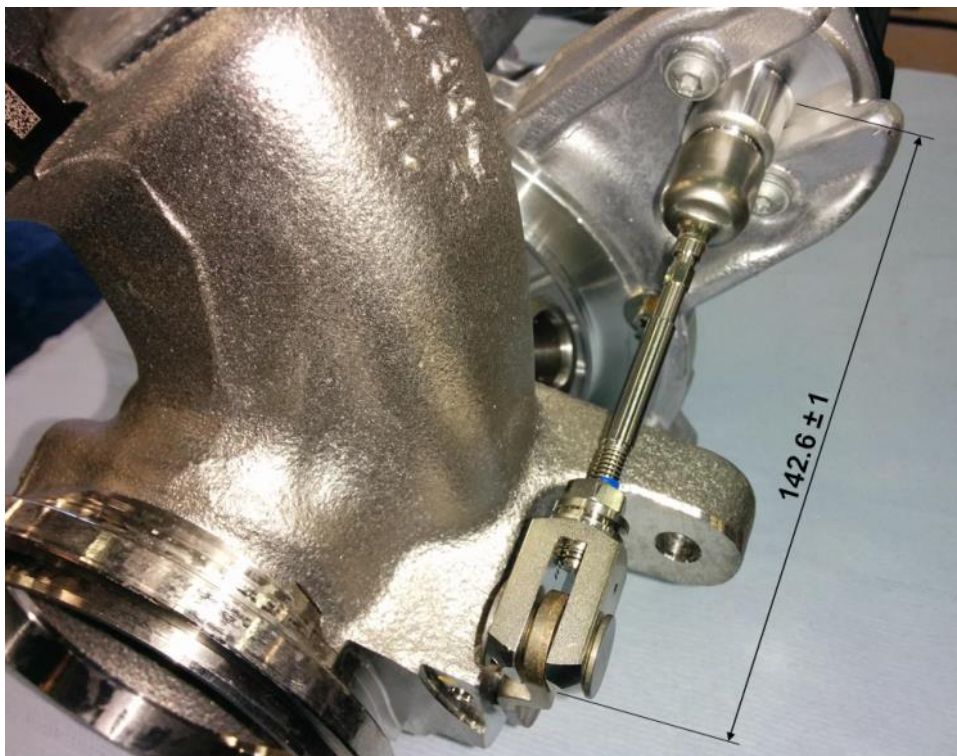
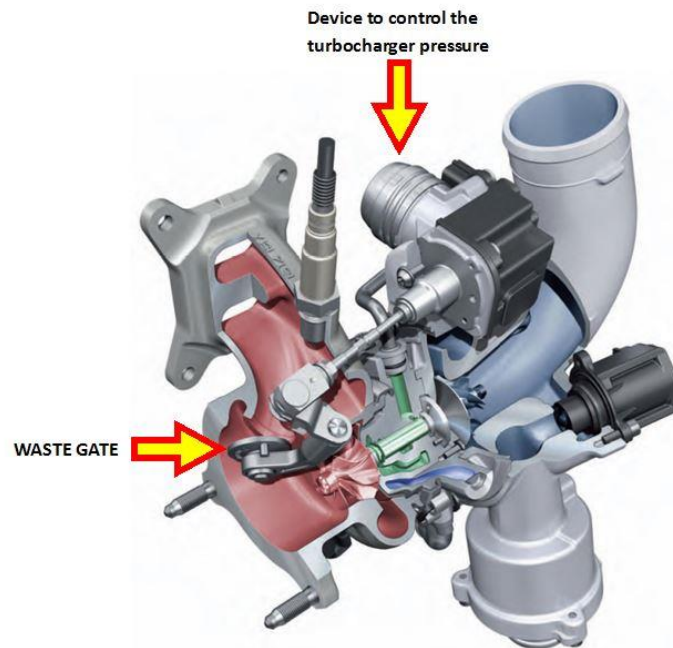

Wastegate Stroke: 8.5mm ± 0.7

## 4. FUEL CIRCUIT

### 401. MODIFIED PRODUCTION FUEL TANK

- |                             |   |
|-----------------------------|---|
| a) Number                   | 1   |
| b) Location                 | Rear and under the bodywork (series position) |
| c) Material                 | Plastic                                       |
| d) Total capacity           | - ± 3 litres                                  |
| e) Location of filler holes | Right side above the rear wheel               |

D1-1) Fuel tank dismounted view from the topD1-2) Fuel tank dismounted view from the bottomD1-3) Fuel tank in its locationD1-4) Fuel tank in its location



# REAL FEDERACIÓN ESPAÑOLA DE AUTOMOVILISMO

Certification N°

TCN2 - C - 001

Make: **SEAT SPORT**

Model: **SEAT Leon Cup Racer V1 / DSG**



REAL FEDERACIÓN ESPAÑOLA DE AUTOMOVILISMO Extension N°

Departamento Técnico  
Technical Department

## SAFETY FUEL TANK

a) Number

Make: Identification

b) Location

c) Material

d) Total capacity

± 3 litres

e) Location of filler holes

D1-5) Fuel tank dismounted

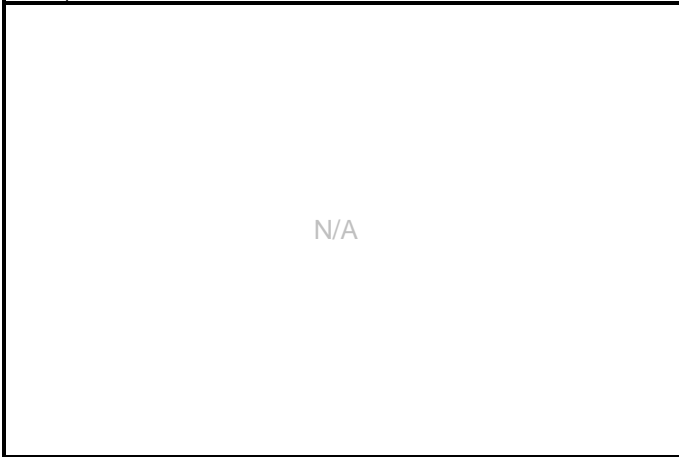

D1-6) Fuel tank vane

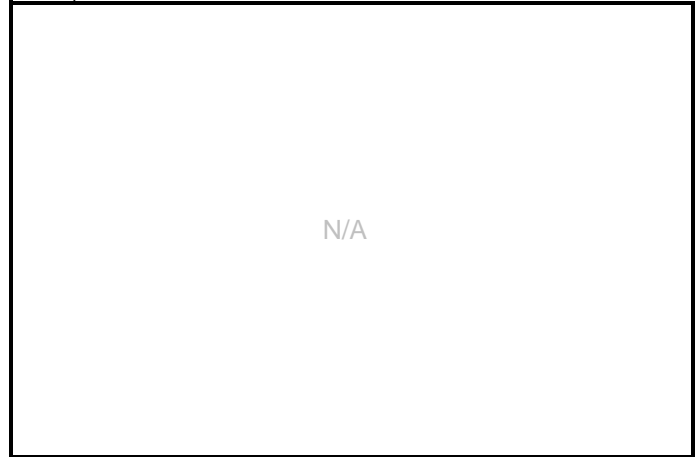

D1-7) Fuel tank in its location

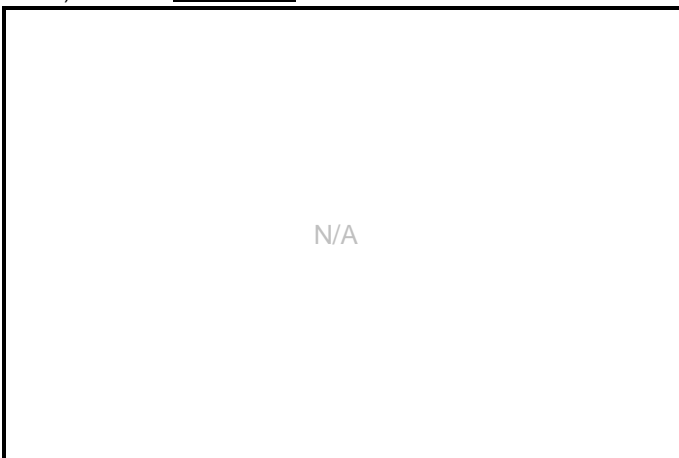

D1-8) Fuel tank in its location

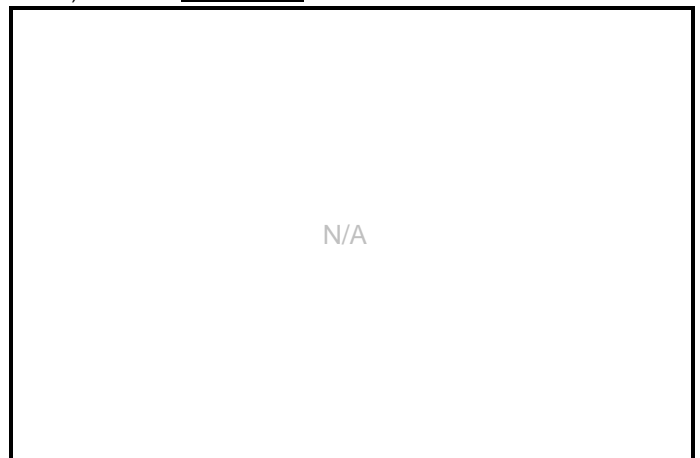



**402. FUEL PUMP(S) BELONGING TO EA888 ENGINE**

a)	Transfer Pumps:	Make: <b>Protec</b>	Type: <b>Centrifugal</b>	Number: <b>1</b>	Location: <b>Fuel tank (left side)</b>
b)	Low pressure pumps:	Make: <b>VW Group</b>	Type: <b>Centrifugal</b>	Number: <b>1</b>	Location: <b>Fuel tank (right side)</b>
f)	HP pump	Make: <b>VW Group</b>	Type: <b>Piston</b>	Number: <b>1</b>	Location: <b>Engine</b>

HP pump cam lift in mm (dismounted camshaft)

Rotation angle (degrees)	Lift (± 0.05 mm)	Rotation angle (degrees)	Lift (± 0.05 mm)
0		0	
- 5		+ 5	
- 10		+ 10	
- 15		+ 15	
- 30		+ 30	
- 45		+ 45	
- 60		+ 60	
- 75		+ 75	
- 90		+ 90	
- 105		+ 105	
- 120		+ 120	
- 135		+ 135	
- 150		+ 150	
- 165		+ 165	
- 180		+ 180	

 D2-1) Fuel pump(s) - dismounted

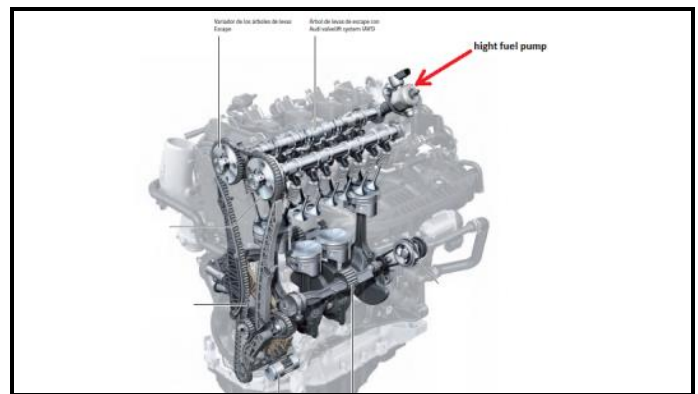
 D2-2) Fuel pump(s) - in its location

 D2-3) Low pressure fuel pump(s) - dismounted

 D2-4) Low pressure fuel pump(s) - in its location

## 5. ELECTRICAL EQUIPMENT

### 501. BATTERY

- a) Type: **Dry 40Ah** Make: **Odissey Extreme**  
b) Location: **Luggage compartment**

E1-1) Battery – dismountedE1-2) Battery – in its location

### 504. STARTER

- a) Position **Above and front of the gearbox.**

E1-3) Starter – dismountedE1-4) Starter – mounted in its location

## WINDSCREEN WIPER

Number of blades: **2** Position: **Bottom of windscreen (left and center)**

E1-3) Windscreen wiper drive – dismounted



E1-4) Windscreen wiper – mounted in its location

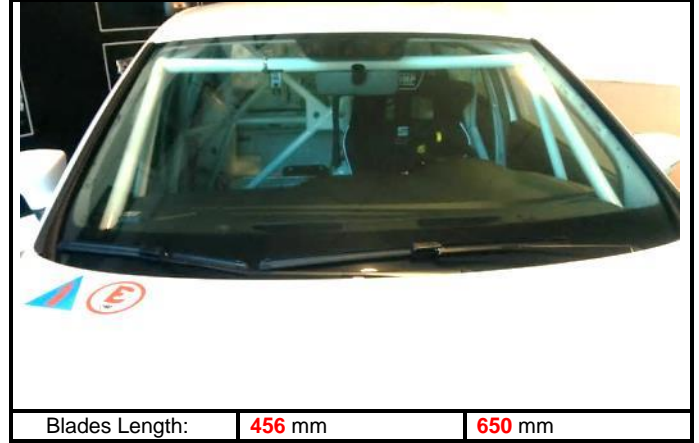

## ENGINE LOOM DRAWING

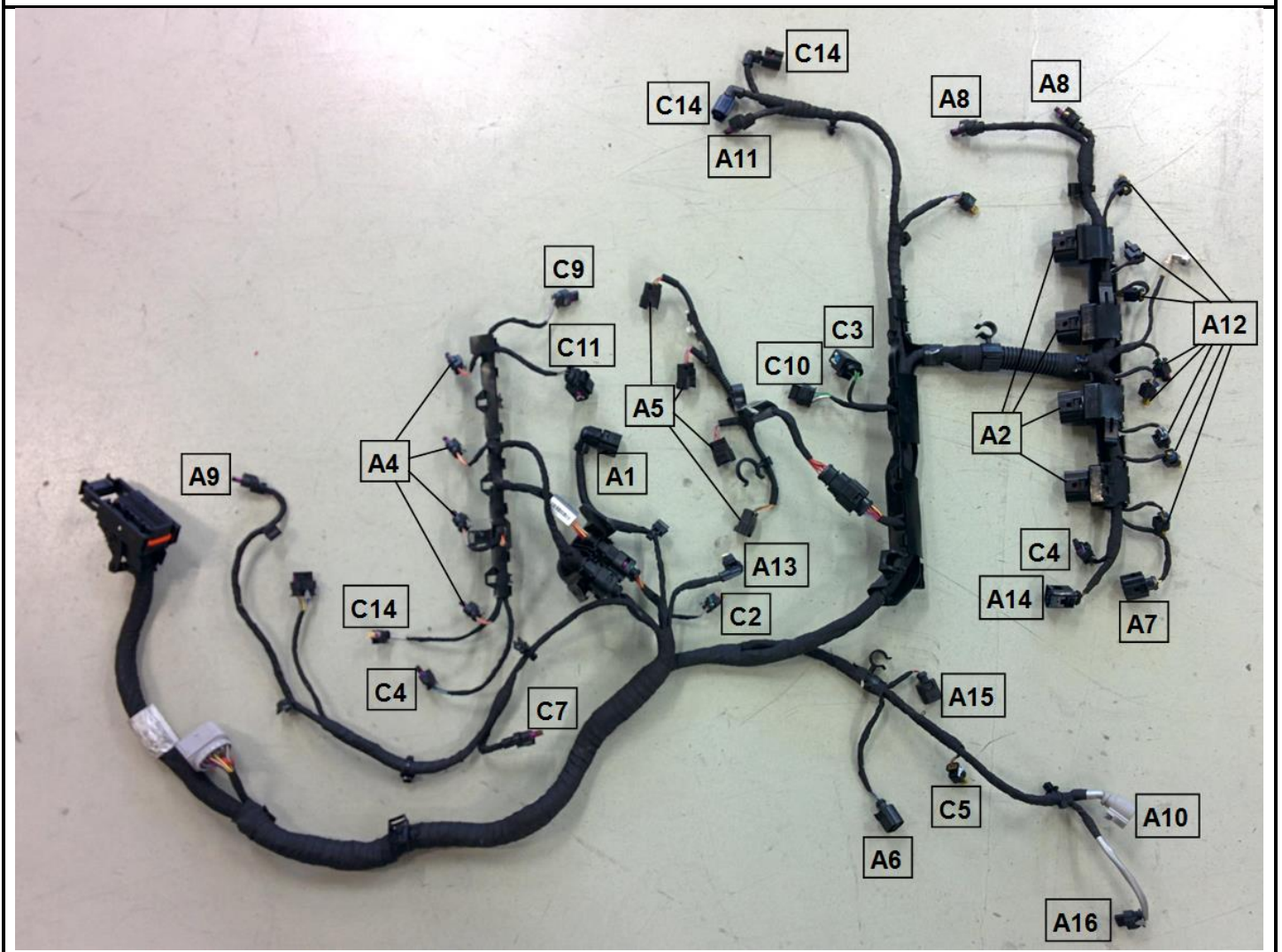



# REAL FEDERACIÓN ESPAÑOLA DE AUTOMOVILISMO

Certification N°

TCN2 - C - 001

Make: **SEAT SPORT**

Model: **SEAT Leon Cup Racer V1 / DSG**



REAL FEDERACIÓN ESPAÑOLA DE AUTOMOVILISMO Extension N°

Departamento Técnico  
Technical Department

## CAR LOOM DRAWING

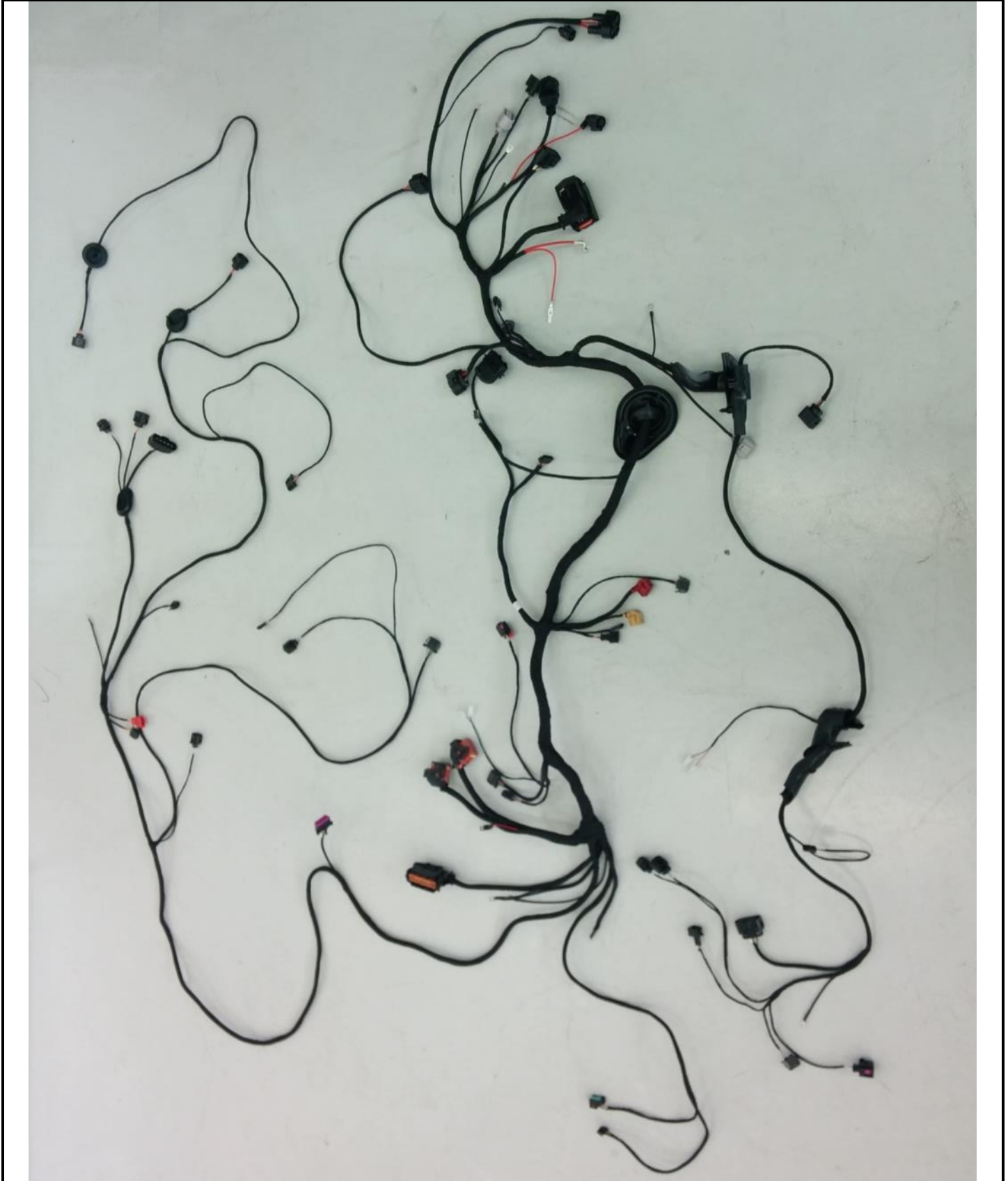

## 6. POWER TRAIN

### 602. CLUTCH INTEGRATED TO GEARBOX

- a) Make and Type : **OEM VW GROUP**      Number of plates: -      Friction diameter of the plate(s): -    ±2mm
  - b) Control system: **Electronic**      Make and Type of clutch release bearing: **OEM VW GROUP**
  - c) Weight: **7.80 kg**      Make and Type of clutch master cylinder: **OEM VW GROUP**
- Power-driven clutch:      Make **OEM VW GROUP**      Identification

F1-1) Clutch dismounted



F1-2) Clutch Control system dismounted



F1-3) Clutch actuation in location



F1-4) Clutch release bearing in location



F1-5) Clutch fluid reservoir in location

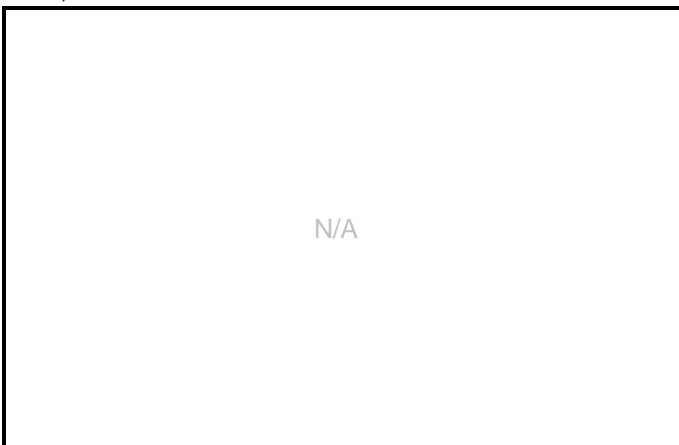

**603. GEARBOX**

 b) Type: **Automatic**

 b1) Weight as shown in F2-1): **91.5 kg ±0.5kg**

 c) Supports: **1**

 d) Type and location of control: **Mechatronic**

 Paddle shift: **Yes**

 Make: **SEAT Sport**

 Identification: **C-XXX**

e) Gear ratios:

MASS PRODUCTION GEARBOX				
	No. of teeth	Ratio	Constant	Synchro
1	13/38	2.923	<input type="checkbox"/>	<input checked="" type="checkbox"/>
2	22/45	2.045	<input type="checkbox"/>	<input checked="" type="checkbox"/>
3	28/41	1.464	<input type="checkbox"/>	<input checked="" type="checkbox"/>
4	38/41	1.078	<input type="checkbox"/>	<input checked="" type="checkbox"/>
5	32/35	1.094	<input type="checkbox"/>	<input checked="" type="checkbox"/>
6	38/35	0.921	<input type="checkbox"/>	<input checked="" type="checkbox"/>
7			<input type="checkbox"/>	<input type="checkbox"/>
AR/R	13/27 14/22	3.264	<input type="checkbox"/>	<input checked="" type="checkbox"/>
Constant				

SEQUENTIAL RACING GEARBOX				
	No. of teeth	Ratio	Constant	Synchro
1			<input type="checkbox"/>	<input type="checkbox"/>
2			<input type="checkbox"/>	<input type="checkbox"/>
3			<input type="checkbox"/>	<input type="checkbox"/>
4			<input type="checkbox"/>	<input type="checkbox"/>
5			<input type="checkbox"/>	<input type="checkbox"/>
6			<input type="checkbox"/>	<input type="checkbox"/>
AR/R			<input type="checkbox"/>	<input type="checkbox"/>
Constant				

 g) Type of lubrication: **Oil pressure**

 h) Cooling: **Water cooling**

F2-1) Gearbox casing and clutch bell housing



F2-2) Gearbox casing and clutch bell housing

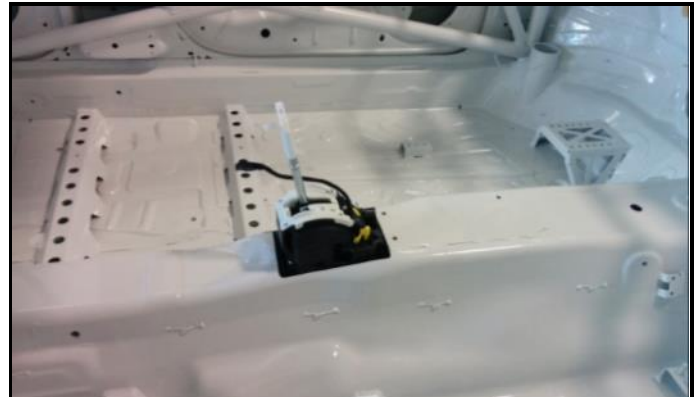

 F2-3) Gearbox command - dismounted

 F2-4) Gearbox command - mounted

Make: **SEAT SPORT**

 Model: **SEAT Leon Cup Racer V1 / DSG**

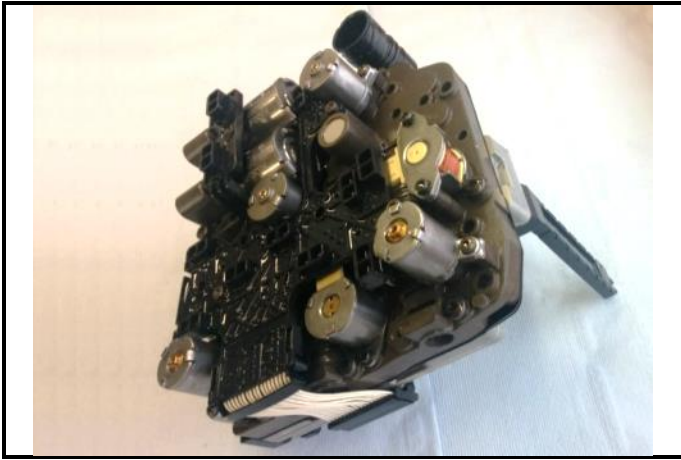
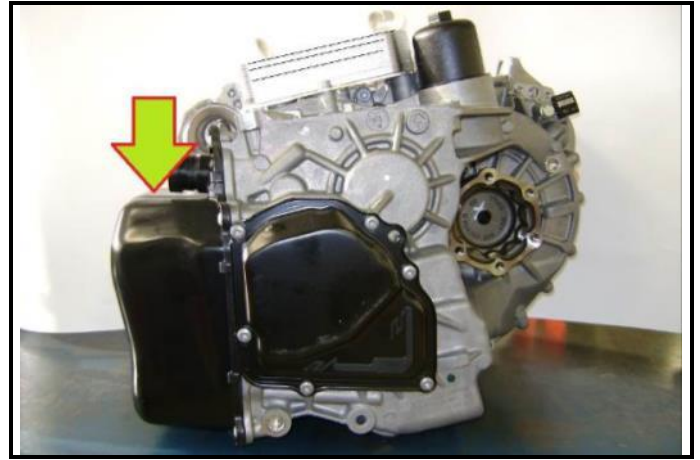
 REAL FEDERACIÓN ESPAÑOLA DE AUTOMOVILISMO Extension N°  
 Departamento Técnico  
 Technical Department

 F2-5) Gearbox control - dismounted

 F2-6) Gearbox control - mounted

 F2-7) Gearbox cooling – dismounted

 F2-8) Gearbox cooling – in location

## 605. FINAL DRIVE

### Mass Production Gear Box

Ratio(s)	Number of Teeth	Used for gears
4.8	15/72	1, 2, 3, 4
3.6	20/72	5, 6

Limited Slip Differential:

 Type: **Electronic**

 Make: **OEM VW GROUP**

 Identification: **D-XXX**

F4-1) Final drive casing



F4-2) Final drive casing

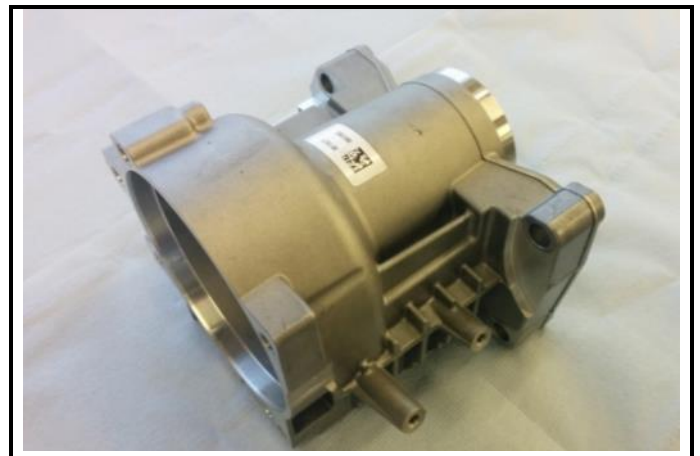

**Make: SEAT SPORT**
**Model: SEAT Leon Cup Racer V1 / DSG**

 REAL FEDERACIÓN ESPAÑOLA DE AUTOMOVILISMO Extension N°  
 Departamento Técnico  
 Technical Department

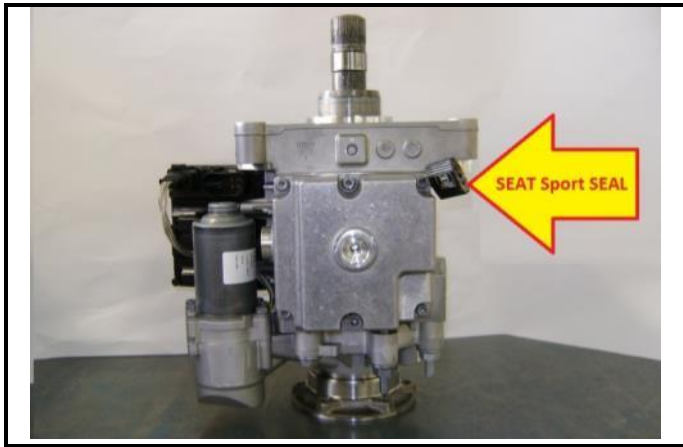
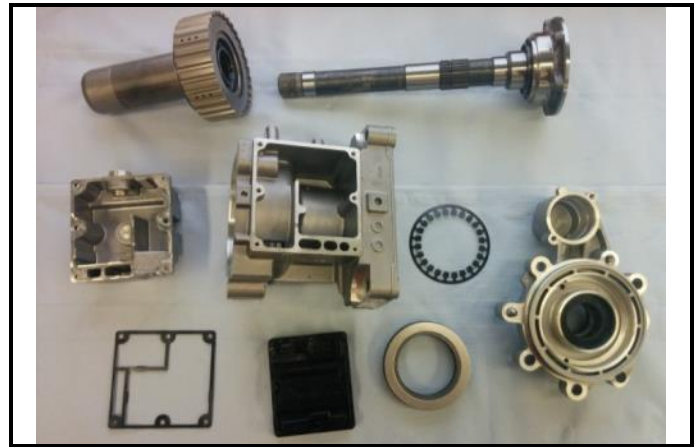
**F4-3) Differential assembly**

**F4-4) Differential dismantled**

**Sequential Gearbox**

Ratio	Teeth Numbers

Limited Slip Differential:

Type:

Make:

Identification:

**F4-5) Differential assembly**

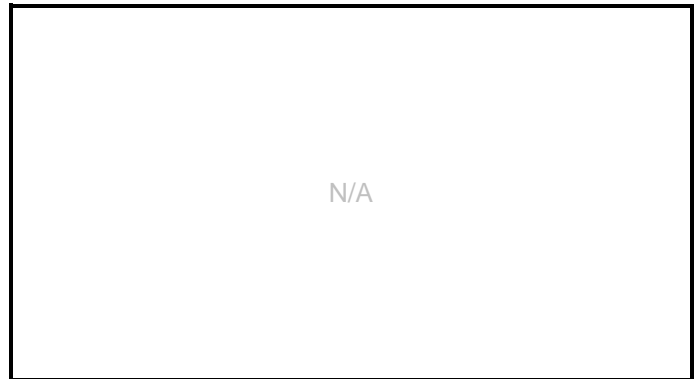
**F4-6) Differential dismantled**

**606. DRIVE SHAFTS**

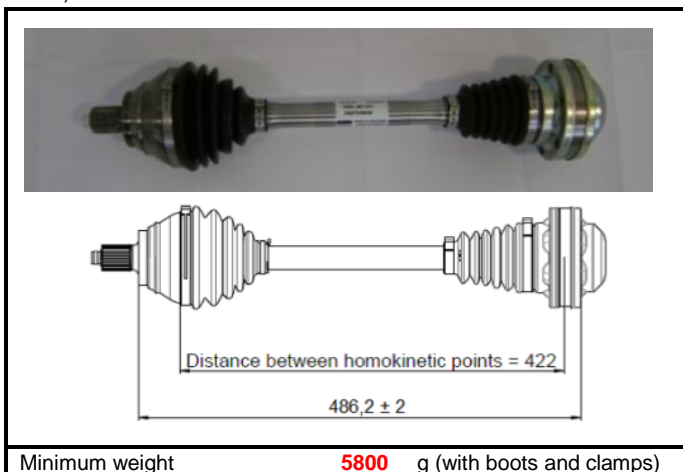
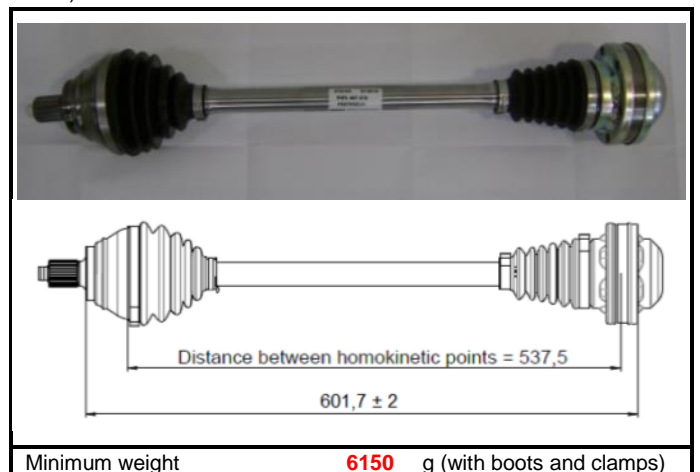
Type :	<b>Motorsport</b>	Make :	<b>GKN</b>
Joint on final drive side:	<b>Lobro joint</b>	Joint on wheel side:	<b>Fixed ball joint</b>

**F5-1) LHS Drive Shaft**

**F5-2) RHS Drive Shaft**



## 7. AXLES, SUBFRAMES AND SUSPENSION

### FRONT

Supports:

Number: **4**

Type: **Bolt**

Shock absorber:

Make & Type: **ZF Sachs**

Setting identification:

G2-1) Subframe dismounted



Minimum weight

**12030** g

G2-2) Subframe in location



G2-3) Subframe – Modification of axle mounting points



G2-4) Subframe – Modification of axle mounting points



G2-5) Subframe – Modification of axle mounting points



G2-6) Subframe – Supports' Modification



Make: **SEAT SPORT**

Model: **SEAT Leon Cup Racer V1 / DSG**



REAL FEDERACIÓN ESPAÑOLA DE AUTOMOVILISMO Extension N°

Departamento Técnico  
Technical Department

G3-1) Bare hub-carrier – dismounted



G3-2) Bare hub-carrier – dismounted



G3-3) Wheel bearing dismounted

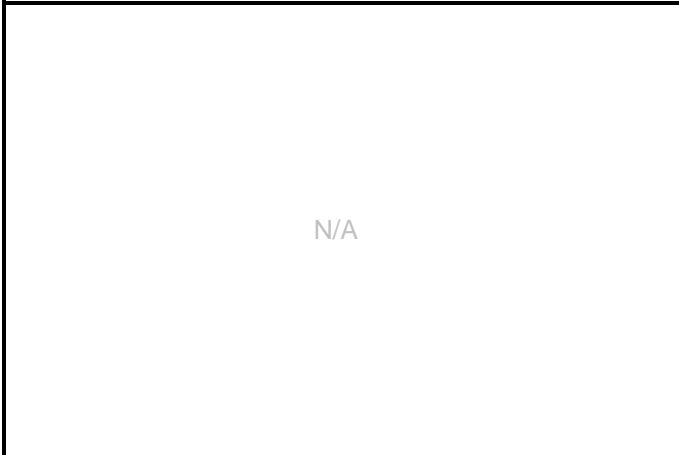

G3-4) Wheel bearing mounted

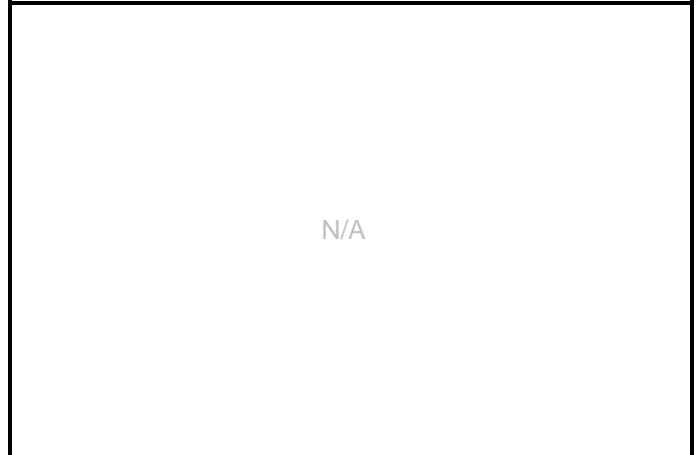

G3-5) Wheel hub dismounted



G3-6) Wheel hub mounted



Make: **SEAT SPORT**

Model: **SEAT Leon Cup Racer V1 / DSG**



REAL FEDERACIÓN ESPAÑOLA DE AUTOMOVILISMO Extension N°  
Departamento Técnico  
Technical Department

G5-1) Complete wishbone/arm **front** – dismounted



Material **steel**  
Minimum weight **2870** g

G5-2) Complete wishbone/arm **front** – dismounted



G5-3) Strut adapter – dismounted

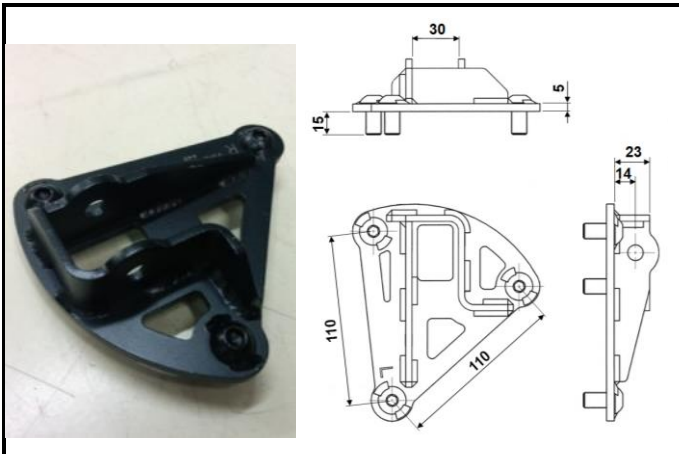

G5-4) Wish bone adapter – dismounted



G6-1) Shock absorber dismounted

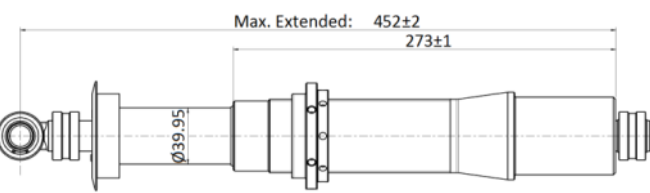

Material **Alluminium**  
Minimum weight **2350** g

G6-2) Shock absorber in location



Make: **SEAT SPORT**

Model: **SEAT Leon Cup Racer V1 / DSG**



REAL FEDERACIÓN ESPAÑOLA DE AUTOMOVILISMO Extension N°

Departamento Técnico  
Technical Department

G7-1) Anti roll bar dismantled

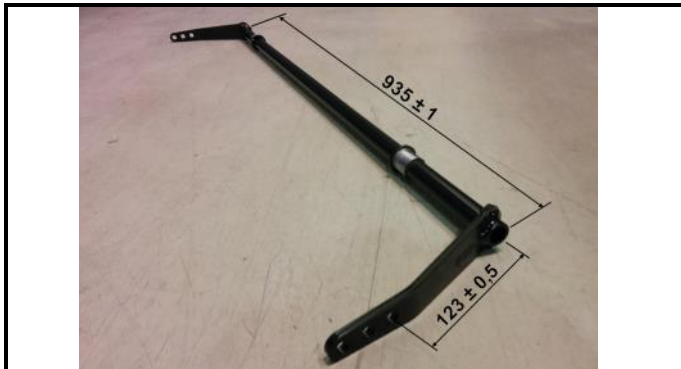

Size	<b>Ø22x2</b>	<b>Ø22x3</b>
Material	<b>Steel</b>	<b>Steel</b>
Minimum weight	<b>1420 g</b>	<b>1800 g</b>

G7-2) Anti roll bar in location

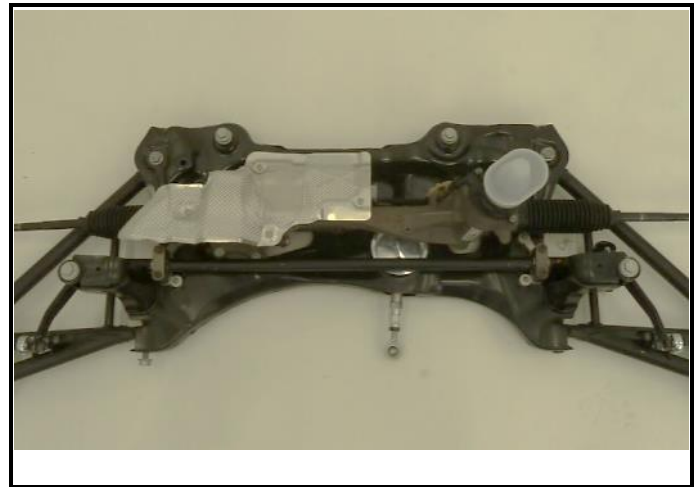

VII-E1) Positions of the pivot points on the wishbone/arm

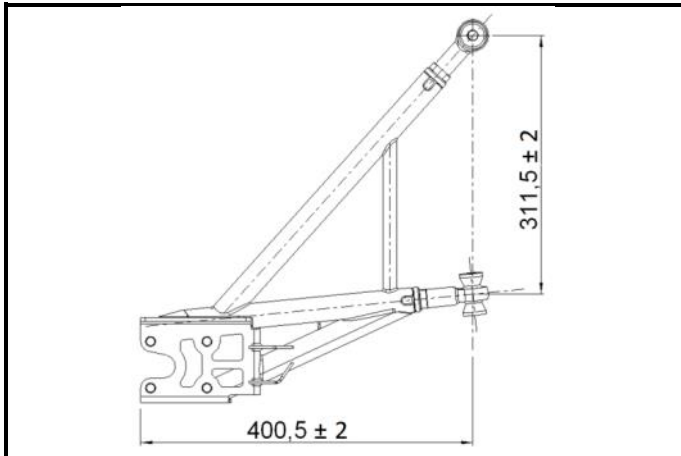

VII-E2) Positions of the pivot points on the wishbone/arm



VII-E3) Pivot points' positions on the body shell / Cross member

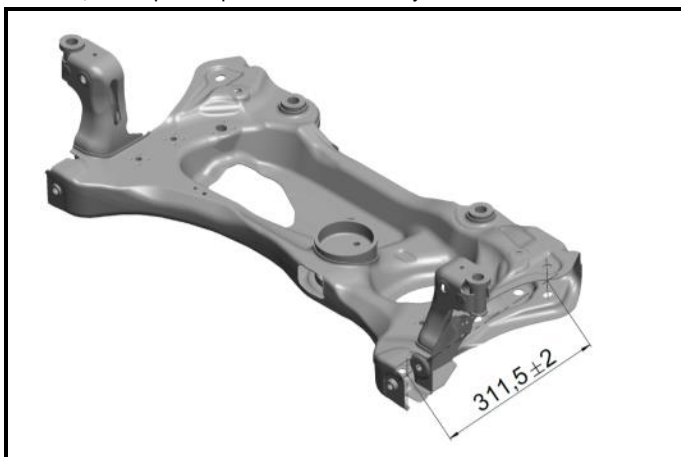



# REAL FEDERACIÓN ESPAÑOLA DE AUTOMOVILISMO

Certification N°

TCN2 – C – 001

Make: **SEAT SPORT**

Model: **SEAT Leon Cup Racer V1 / DSG**



REAL FEDERACIÓN ESPAÑOLA DE AUTOMOVILISMO Extension N°

Departamento Técnico  
Technical Department

## REAR

Supports:

Number: **4**

Type: **Bolt**

Shock absorber:

Make & Type: **ZF Sachs**

Setting identification:

H2-1) Subframe dismounted



Minimum weight **11350** g (without bolts)

H2-2) Subframe in location



H2-3) Subframe – Modification of axle mounting points



H2-4) Subframe – Modification of axle mounting points



H2-5) Subframe – Modification of axle mounting points

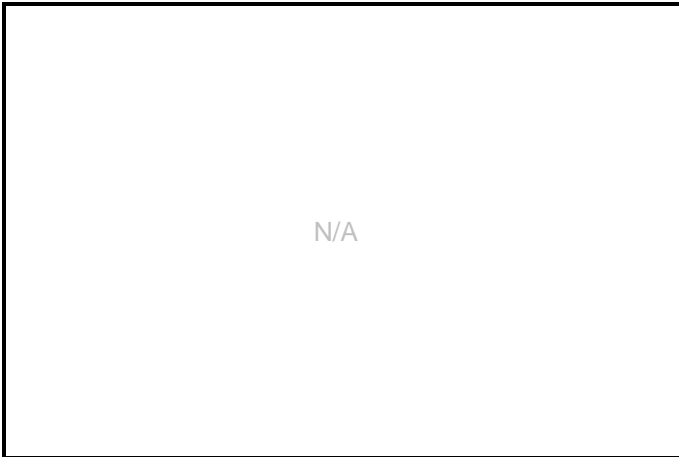

H2-6) Subframe – Supports' Modification

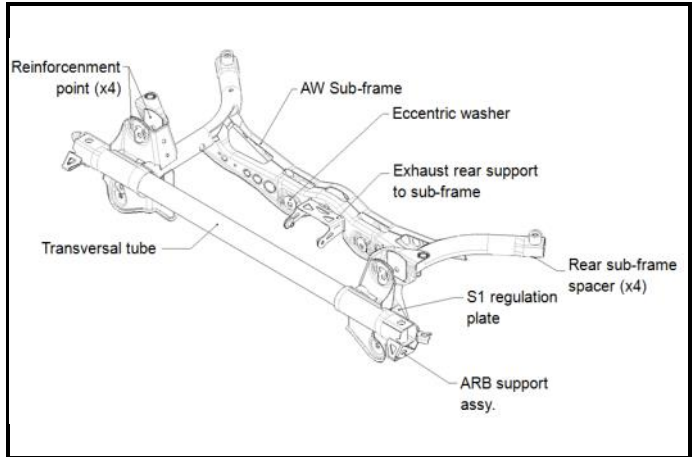

Make: **SEAT SPORT**

Model: **SEAT Leon Cup Racer V1 / DSG**



REAL FEDERACIÓN ESPAÑOLA DE AUTOMOVILISMO Extension N°

Departamento Técnico  
Technical Department

H3-1) Bare hub-carrier – dismounted



H3-2) Bare hub-carrier – dismounted



H3-3) Wheel bearing dismounted

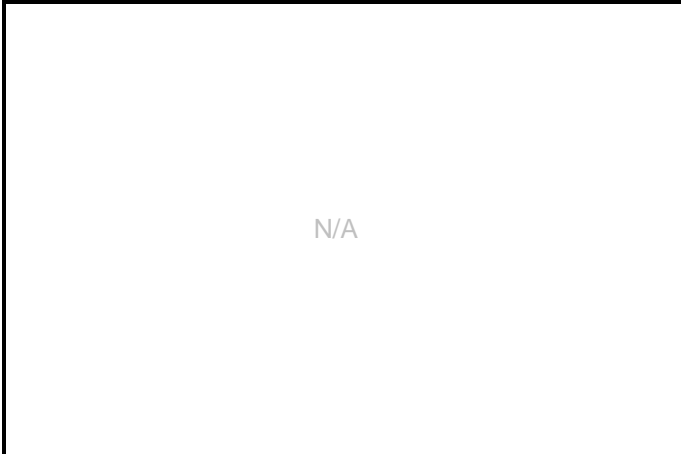

H3-4) Wheel bearing mounted

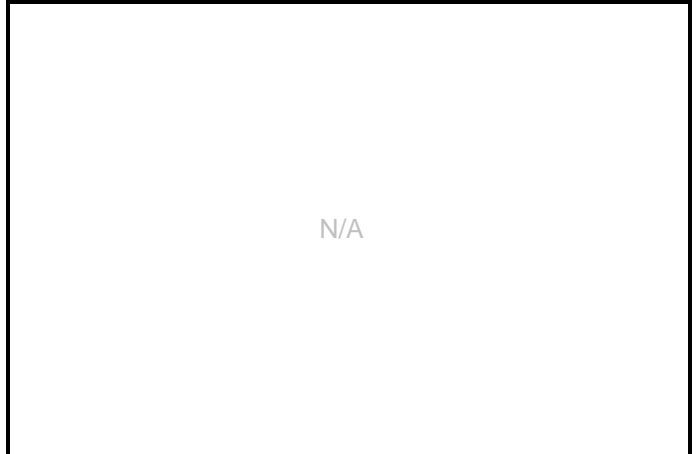

H3-5) Wheel hub dismounted



H3-6) Wheel hub mounted



Make: **SEAT SPORT**

Model: **SEAT Leon Cup Racer V1 / DSG**



REAL FEDERACIÓN ESPAÑOLA DE AUTOMOVILISMO Extension N°  
Departamento Técnico  
Technical Department

H5-1) Complete wishbone/arm **Upper** – dismounted

Material	<b>Steel</b>
Minimum weight	<b>1400</b> g (with ball joints)

H5-2) Complete wishbone/arm **Lower-Front** – dismounted

Material	<b>Steel</b>
Minimum weight	<b>765</b> g (with ball joints)

H5-3) Adapter Shock Absorber – dismounted

H5-4) Wish bone adapter – dismounted

N/A

H6-1) Shock absorber dismounted

Material	<b>Aluminium</b>
Minimum weight	<b>1550</b> g

H6-2) Shock absorber in location



Make: **SEAT SPORT**

Model: **SEAT Leon Cup Racer V1 / DSG**



REAL FEDERACIÓN ESPAÑOLA DE AUTOMOVILISMO Extension N°

Departamento Técnico  
Technical Department

H7-1) Anti roll bar dismounted



Size	<b>Ø22x3</b>	<b>Ø22x4</b>
Material	<b>Steel</b>	<b>Steel</b>
Minimum weight	<b>2140 g</b>	<b>2580 g</b>

H7-2) Anti roll bar in location



VIII-E1) Positions of the pivot points on the wishbone/arm

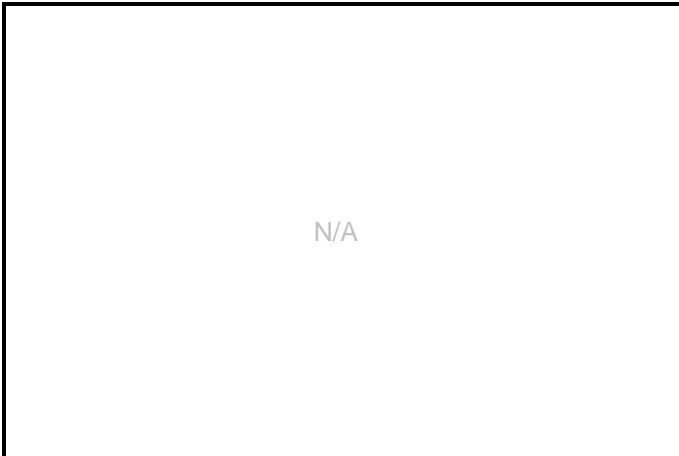

VIII-E2) Positions of the pivot points on the wishbone/arm

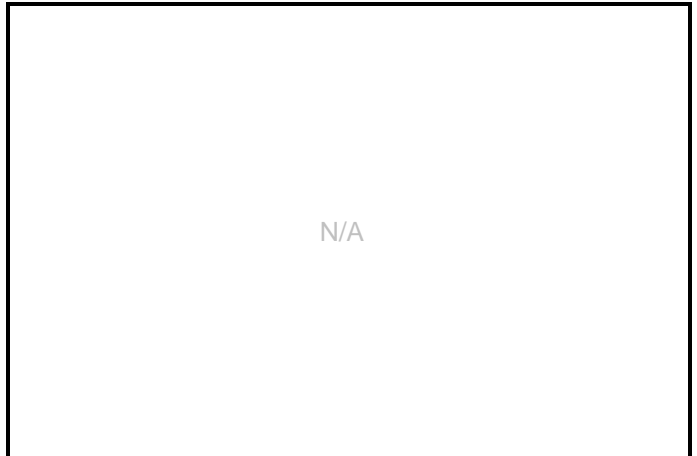

VIII-E3) Pivot points' positions on the body shell / Cross member

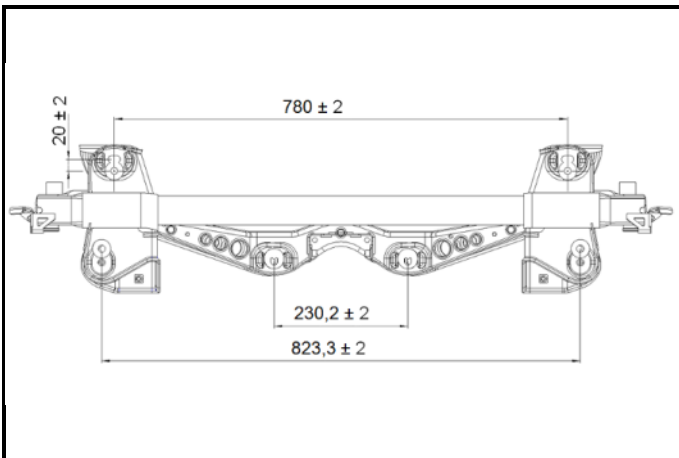



## 8. RUNNING GEAR

### 801. WHEELS

Make: **SEAT SPORT**Identification: **SEAT SPORT**Weight: **11.75** kg ±0.5kg

I1-1) Wheel dismounted ¾ from outside



I1-2) Wheel dismounted ¾ from inside



I1-3) Front wheel attachment dismounted



I1-4) Rear wheel attachment dismounted



I1-5) Front wheel spacer

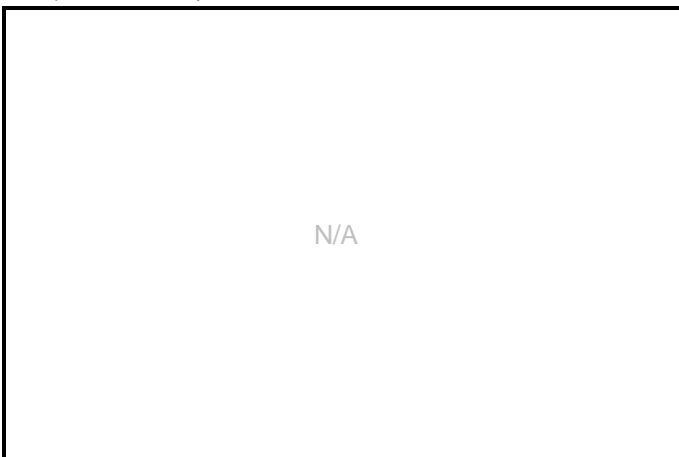

I1-6) Rear wheel spacer



**803. BRAKES**

a) Braking system

 b) Number of master cylinders: **2**

c) Servo brakes:

d) Braking regulator(s)

Make and type :

**AP Racing**

Location

**Cockpit**
**No**

c1) Make and type :

 d1) Location(s) **Pedal box**

d2) Type(s):

**Mechanical**

 d2) Hydraulic pressure valve: **25/3**

e) Number of cylinders per wheel

e1) Bore

g1) Number of pads per wheel

g2) Number of callipers per wheel

g3) Calliper material

g4) Thickness of new disc

g5) External diameter of disc

	FRONT	REAR
e)	6	2
e1)	27 / 31.8 / 38.1 ± 0.1 mm	36 ± 0.1 mm
g1)	2	2
g2)	1	1
g3)	Aluminium	Aluminium / Steel
g4)	34 ± 1mm	10 ± 1mm
g5)	378 ± 1.5mm	272 ± 1.5 mm

**h) Parking brake**

h1) Type

**Gearbox**

h2) Location of control

**Gearbox lever**

J4-1) Master cylinders dismantled



J4-2) Master cylinders in location



J5-1) Braking Regulator dismantled



J5-2) Braking Regulator in location

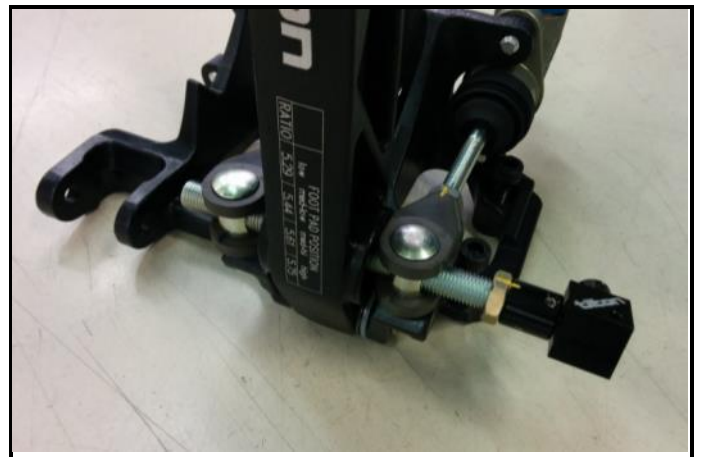

Make: **SEAT SPORT**

Model: **SEAT Leon Cup Racer V1 / DSG**



REAL FEDERACIÓN ESPAÑOLA DE AUTOMOVILISMO Extension N°  
Departamento Técnico  
Technical Department

J6-1) Front brake calliper



J6-2) Rear brake calliper



J7-1) Front brake disc bell



J7-2) Rear brake disc bell



J8-1) Brake fluid tank(s) in location



J8-2) Hydraulic pressure valve in location

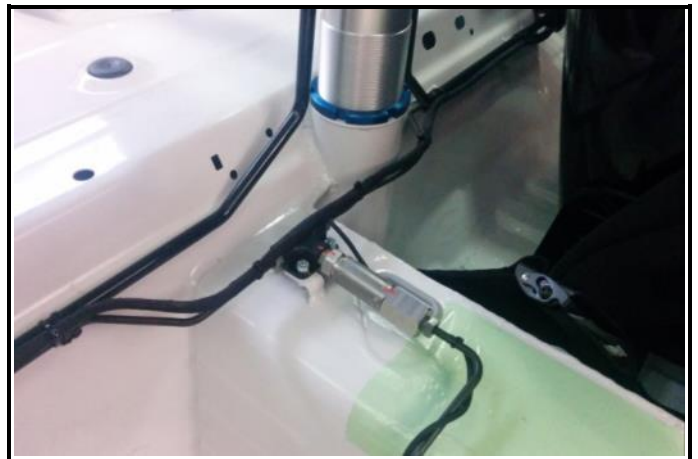



# REAL FEDERACIÓN ESPAÑOLA DE AUTOMOVILISMO

Certification N°

TCN2 - C - 001

Make: **SEAT SPORT**

Model: **SEAT Leon Cup Racer V1 / DSG**



REAL FEDERACIÓN ESPAÑOLA DE AUTOMOVILISMO Extension N°

Departamento Técnico  
Technical Department

J9-1) Parking brake dismounted

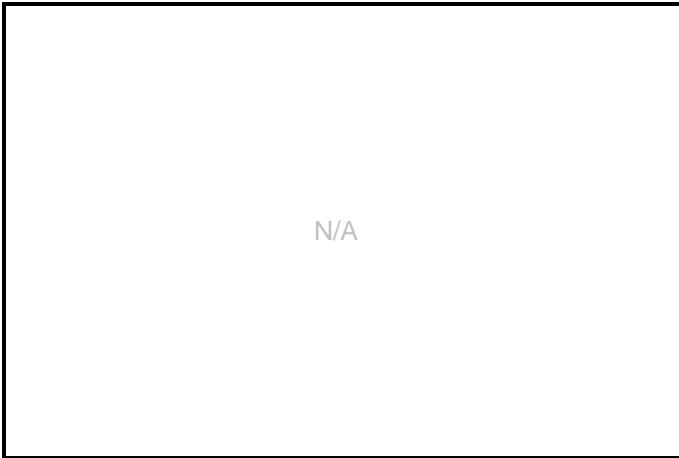

J9-2) Parking brake in the car

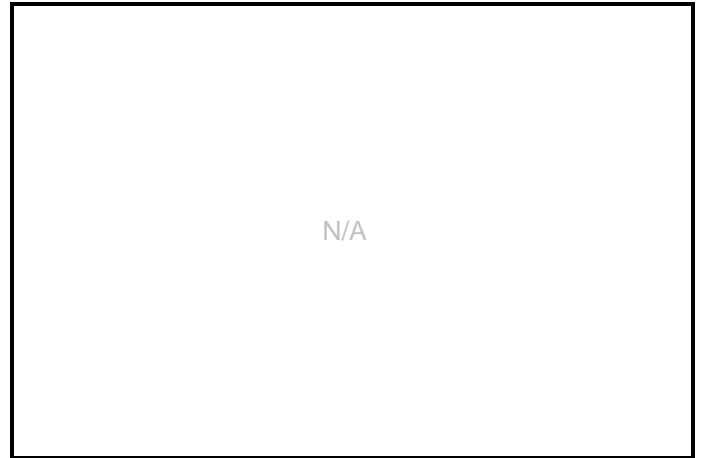

J10-1) Front brake cooling

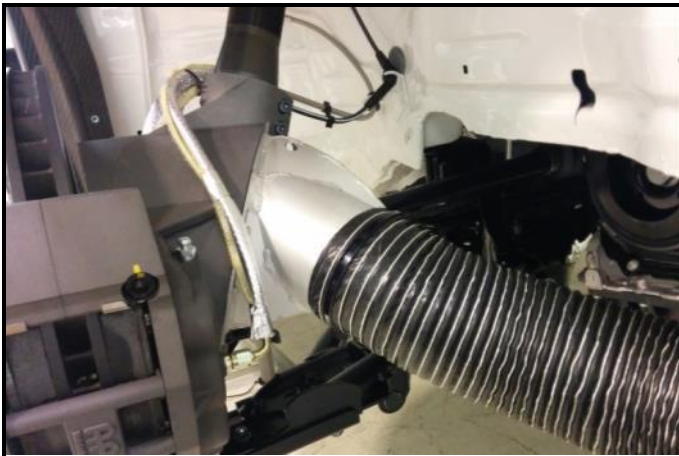

J10-2) Rear brake cooling

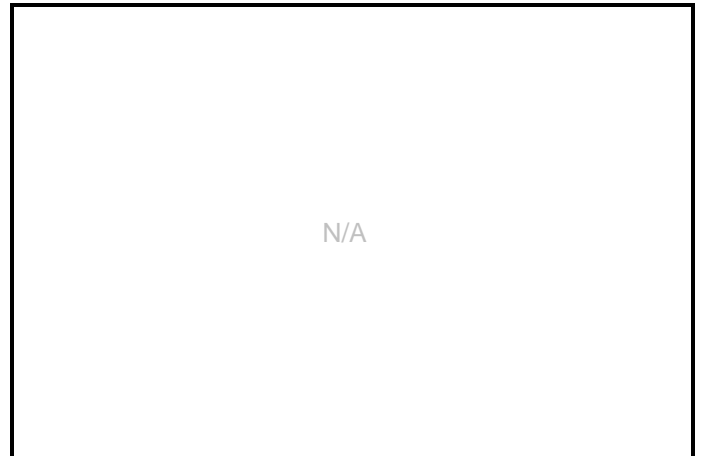

## 804. STEERING

Type: **RACK AND PINION**

Origin and identification: **OEM VW GROUP**

J11-1)Steering mechanism - dismounted



J11-2)Steering mechanism – in location

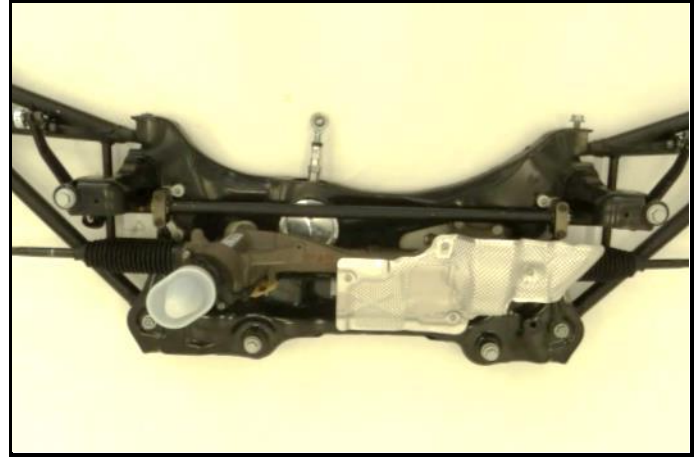

J11-3)Steering column - dismounted

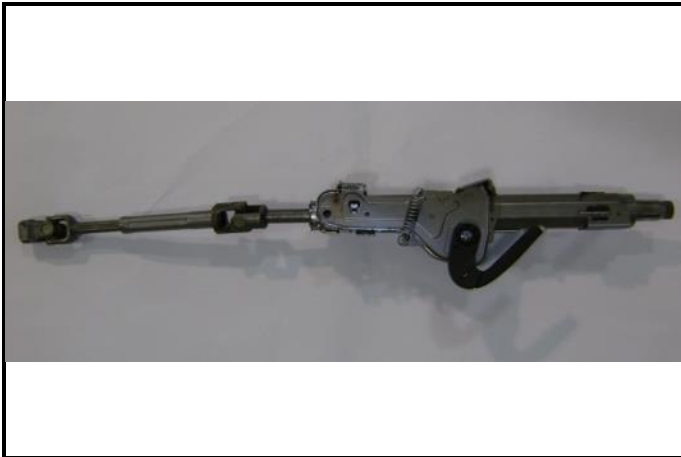

J11-4)Steering column – in location

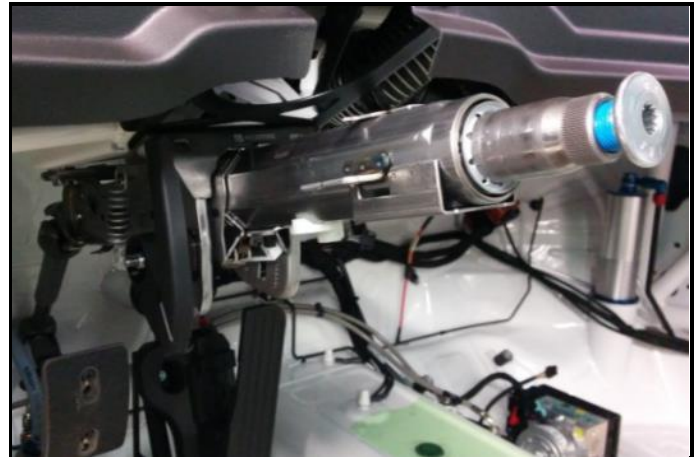

J12-1)Steering wheel



J12-2)Steering wheel release mechanism



Make: **SEAT SPORT**Model: **SEAT Leon Cup Racer V1 / DSG**

## 9. BODYWORK - CHASSIS (BODYSHELL)

### 901. INTERIOR

#### Driver Seat

Make and Type 1: **OMP**

Make and Type 2 (option):

Dash Board: **SEAT Sport**Material: **Plastic**Weight: **2150g** ±250g (with lateral covers)

Driver Seat Type 1 with brackets

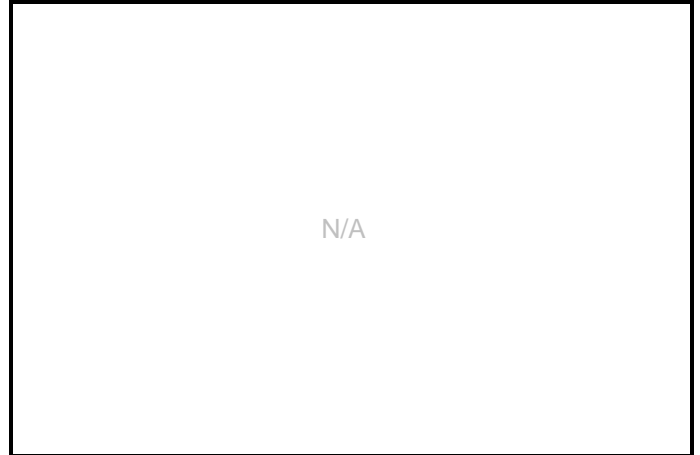

Driver Seat Type 2 with brackets

L1-1) Dashboard - dismounted

L1-2) Dashboard and centre console (steering wheel removed)



L1-3) Instruments



L1-4) Switches panel



L2-1) Pedal box - dismounted seen from front



L2-2) Pedal box - dismounted seen from side



L2-3) Pedal box - mounted in its location

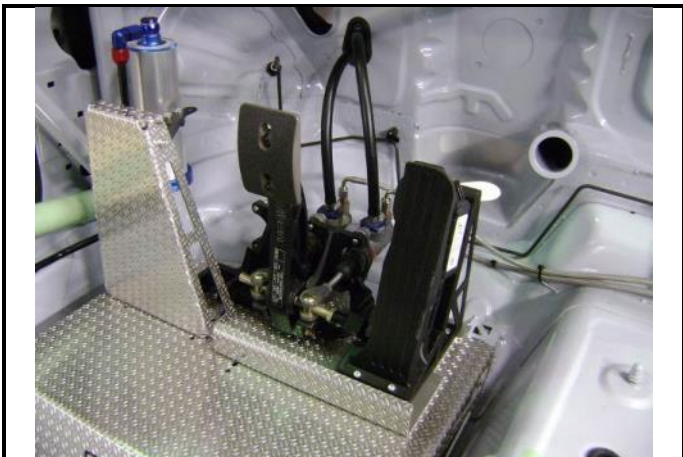

XII-A2) Longitudinal position of the original back seat





# REAL FEDERACIÓN ESPAÑOLA DE AUTOMOVILISMO

Certification N°

TCN2 - C - 001

Make: **SEAT SPORT**

Model: **SEAT Leon Cup Racer V1 / DSG**



REAL FEDERACIÓN ESPAÑOLA DE AUTOMOVILISMO Extension N°  
Departamento Técnico  
Technical Department

L3-1) Optional front side impact panel dismantled

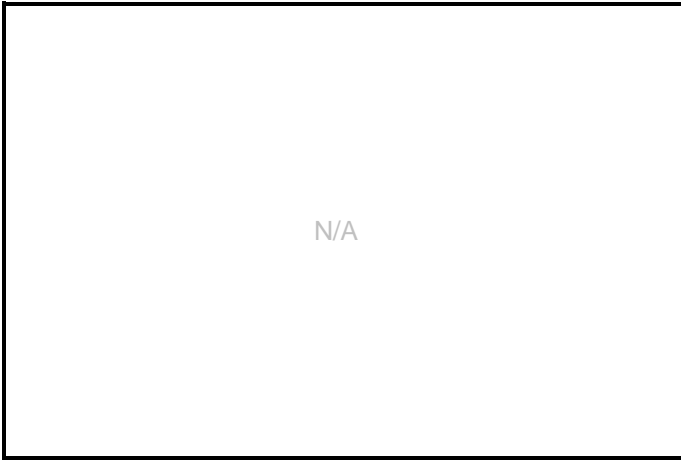

L3-2) Optional front side impact panel in location

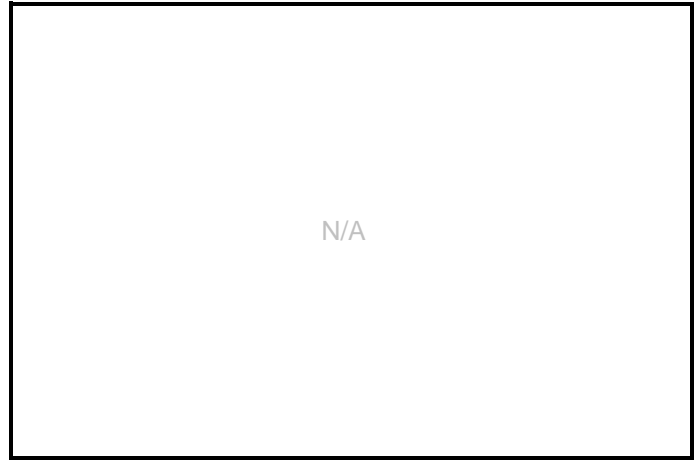

L3-3) Optional rear side impact panel dismantled

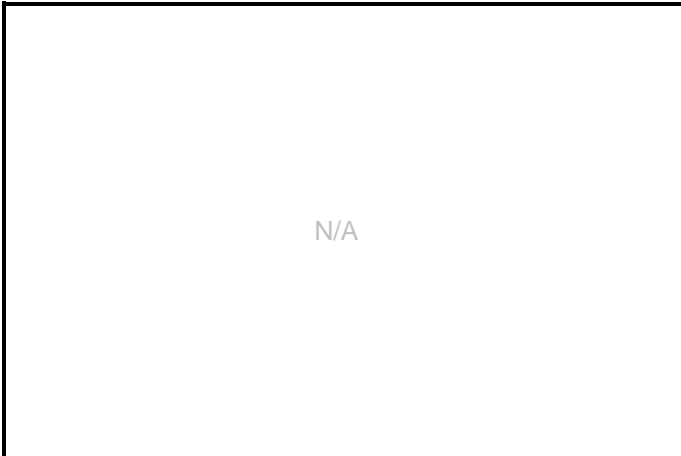

L3-4) Optional rear side impact panel in location

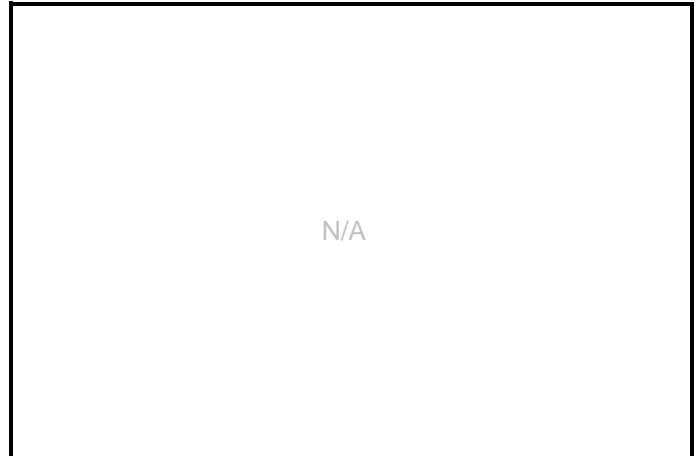





# REAL FEDERACIÓN ESPAÑOLA DE AUTOMOVILISMO

Certification N°

TCN2 – C – 001

Make: **SEAT SPORT**

Model: **SEAT Leon Cup Racer V1 / DSG**



REAL FEDERACIÓN ESPAÑOLA DE AUTOMOVILISMO Extension N°  
Departamento Técnico  
Technical Department

## 902. EXTERIOR

### XIII-A1) MATERIALS OF BODYWORK PANELS

#### METALLIC MATERIALS

Identification	Part	Material	Weight
1	BONNET	STEEL	12000 g
2	LEFT / RIGHT FRONT BONNET	STEEL	14600 g
3	LEFT RIGHT REAR BONNET	STEEL	11400 g
4	ROOF	STEEL	- g
5	BOOT LID	STEEL	10600 g

#### PLASTIC MATERIALS

Identification	Part	Material	Weight
11	BONNET OPENING	CARBON	380 g
12	FRONT SPLITTER	CARBON	3900 g
13	FENDER AIR EXIT	CARBON	170 g
14	FRONT BUMPER	FIBER GLASS	3800 g
15	REAR BUMPER	FIBER GLASS	6500 g
16	LEFT /RIGHT SIDE SKIRT PANEL	COMPOSITE	600 g
17	LEFT / RIGHT REAR DOOR EXTENSION	CARBON (painted)	600 g
18	LEFT / RIGHT REAR FENDER EXTENSION	CARBON (painted)	420 g
19	LEFT / RIGHT FRONT FENDER	CARBON (painted)	900 g

#### GLAZING

Identification	Part	Material	Minimum thickness
21	WINDSCREEN	GLASS	4.46 ± 0.3 mm
22	LEFT / RIGHT FRONT DOOR WINDOW	GLASS	3.85 ± 0.2 mm
23	LEFT / RIGHT REAR DOOR WINDOW	GLASS	3.15 ± 0.2 mm
24	LEFT / RIGHT REAR TRIANGLE WINDOW	PLASTIC	3.15 ± 0.2 mm
25	REAR WINDOW	PLASTIC	4.00 ± 0.3 mm

## BODYWORK PANELS (DRAWING)

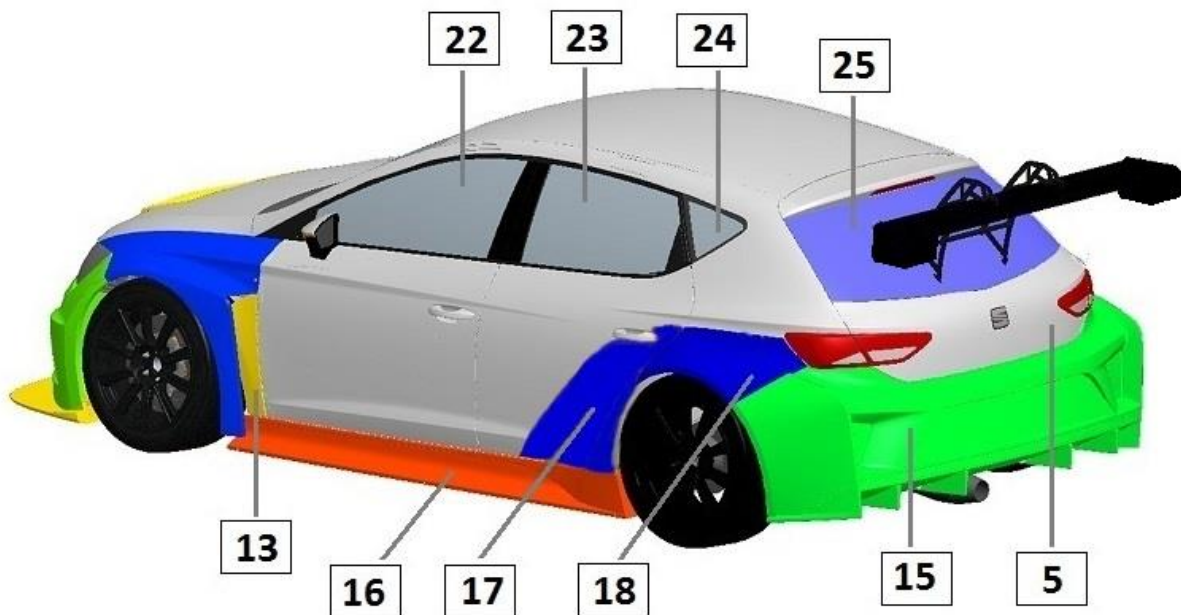
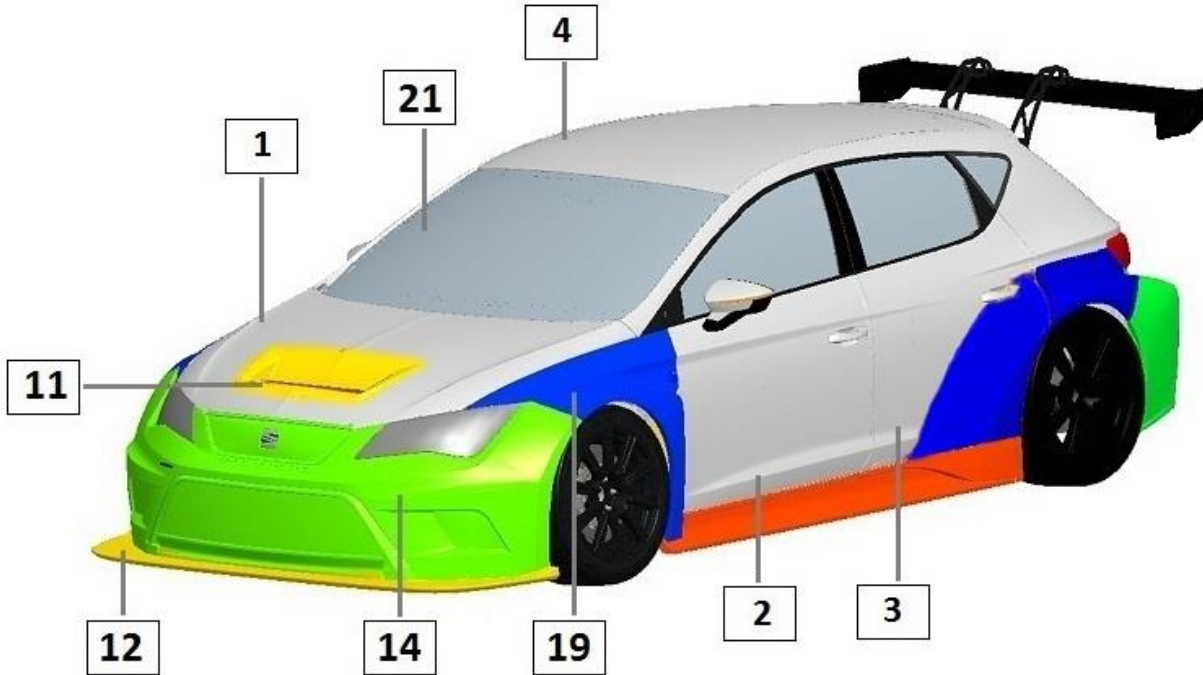

M4-1) Engine bonnet – dismounted (outside)

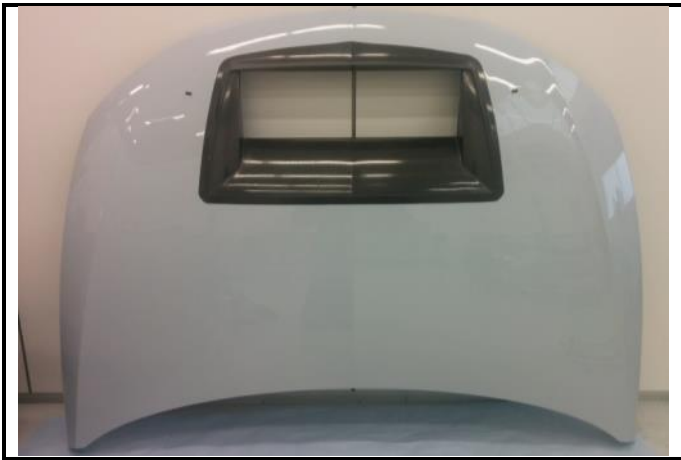

M4-2) Engine bonnet – dismounted (inside)



XIII-D1) Engine bonnet – dimensions of openings

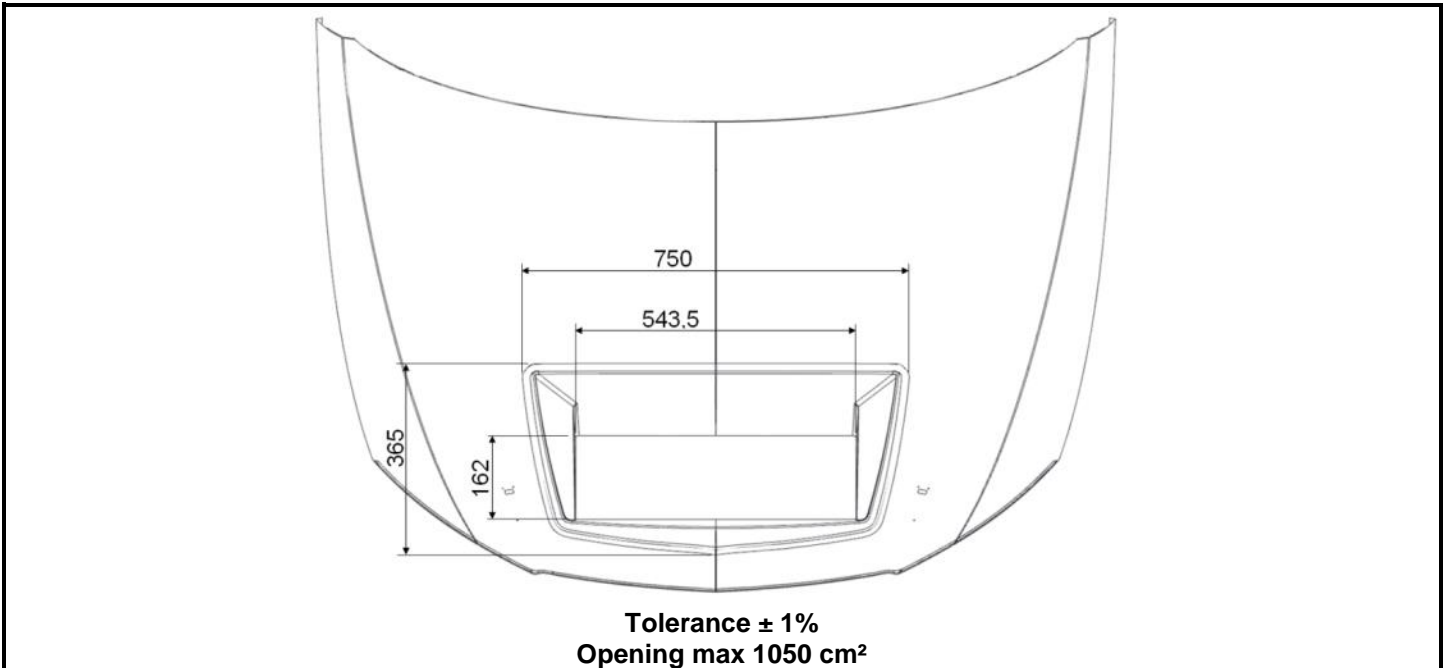

M5-1) Engine bonnet open - retaining support(s)



M5-2) Boot lid open - retaining support(s)

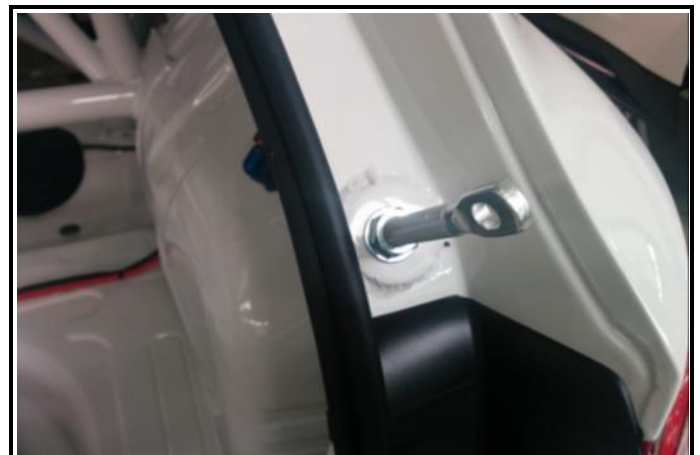

Make: **SEAT SPORT**

Model: **SEAT Leon Cup Racer V1 / DSG**



REAL FEDERACIÓN ESPAÑOLA DE AUTOMOVILISMO Extension N°

Departamento Técnico  
Technical Department

M5-3) Front fender dismantled



M5-4) Front fender in location



M6-1) Rear fender - dismantled

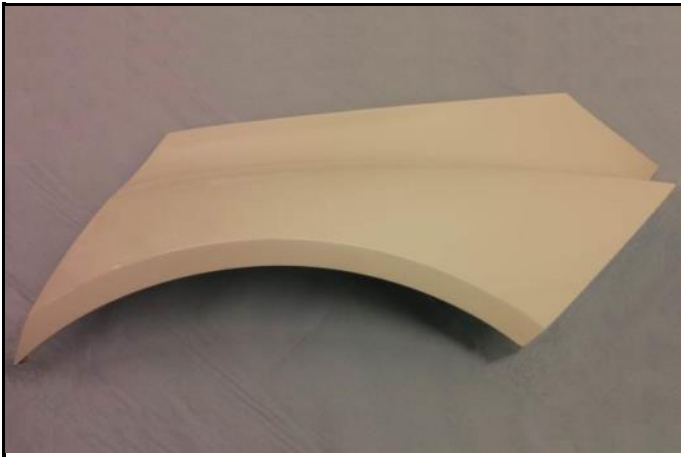

M6-2) Rear fender in location



M7-1) Bare front door – inner face



M7-2) Front door inner face

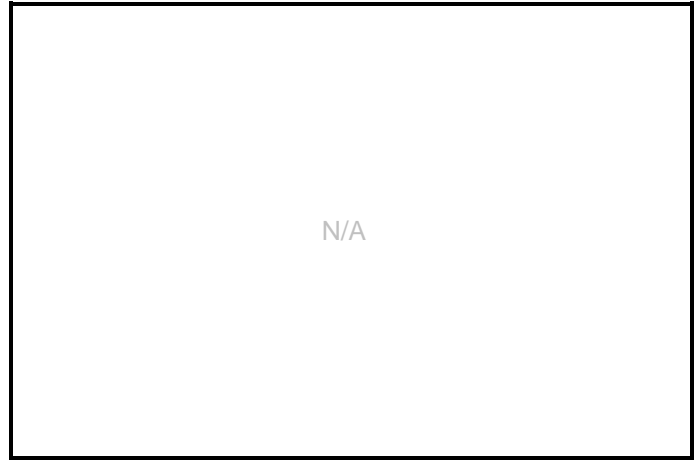
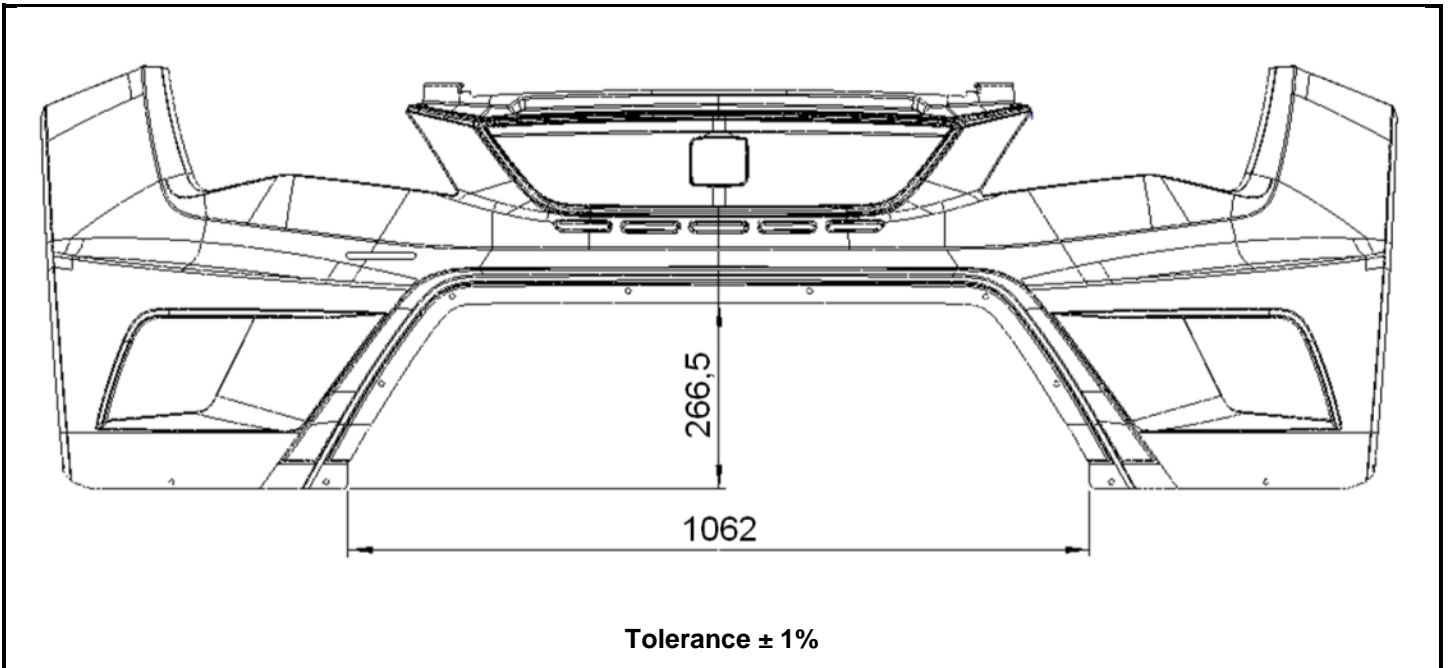

Make: **SEAT SPORT**Model: **SEAT Leon Cup Racer V1 / DSG**REAL FEDERACIÓN ESPAÑOLA DE AUTOMOVILISMO Extension N°  
Departamento Técnico  
Technical DepartmentM8-1) Bare rear door – inner faceM8-5) Rear door – modification of wheel archM9-1) Front bumper - dismounted outer sideMinimum weight **3800** gM9-2) Front bumper - dismounted inner sideXIII-II) Front bumper seen from front - dimensions of openings

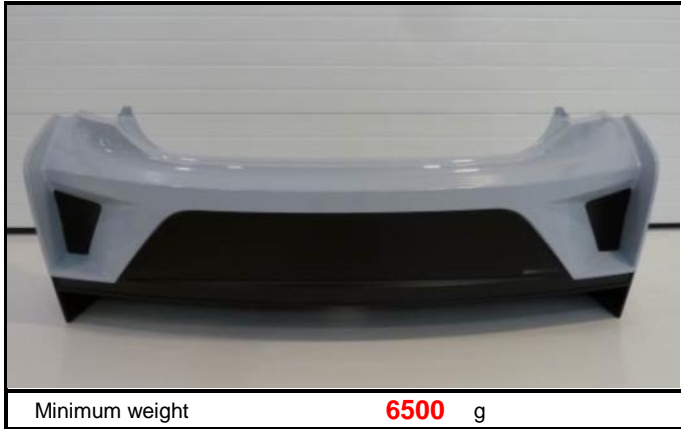
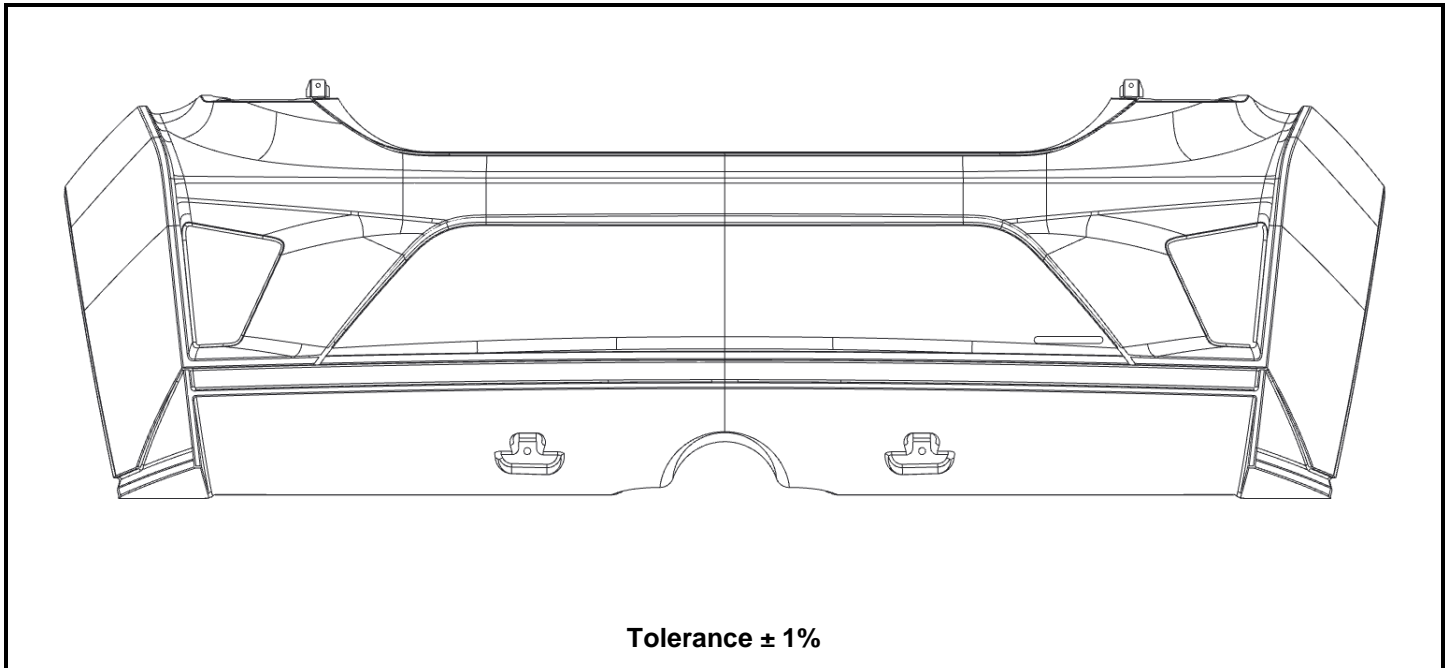
Make: **SEAT SPORT**Model: **SEAT Leon Cup Racer V1 / DSG**REAL FEDERACIÓN ESPAÑOLA DE AUTOMOVILISMO Extension N°  
Departamento Técnico  
Technical DepartmentM11-1) Rear bumper - dismounted outer side (¾ from below)Minimum weight **6500** gM11-2) Rear bumper - dismounted inner sideXIII-11) Rear bumper - dimensions of diffuserTolerance  $\pm 1\%$ 

M12-1) Front wheel arch liner

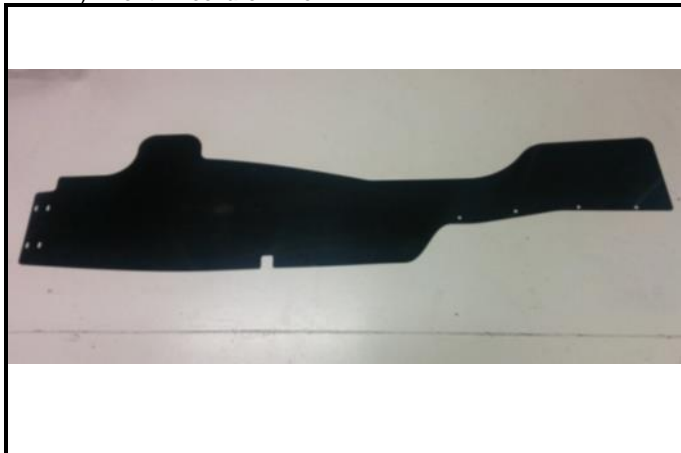

M12-2) Rear wheel arch liner



Make: **SEAT SPORT**

Model: **SEAT Leon Cup Racer V1 / DSG**



REAL FEDERACIÓN ESPAÑOLA DE AUTOMOVILISMO Extension N°  
Departamento Técnico  
Technical Department

M14-1) Complete rear wing - dismounted



M14-2) Complete rear wing - dismounted

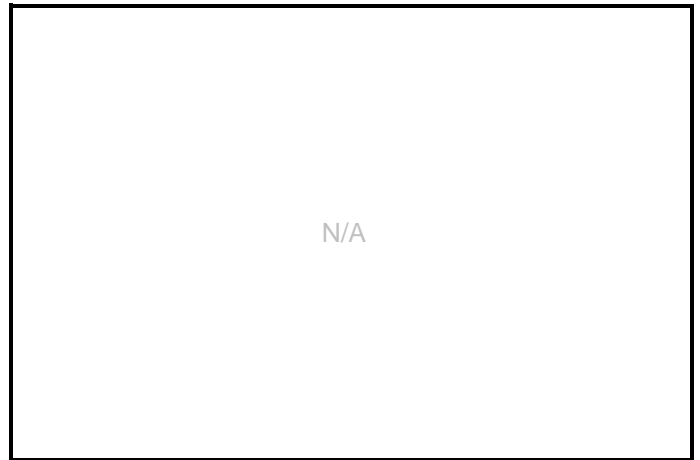

M14-3) Complete rear wing - mounted on car



M14-4) Rear wing regulation

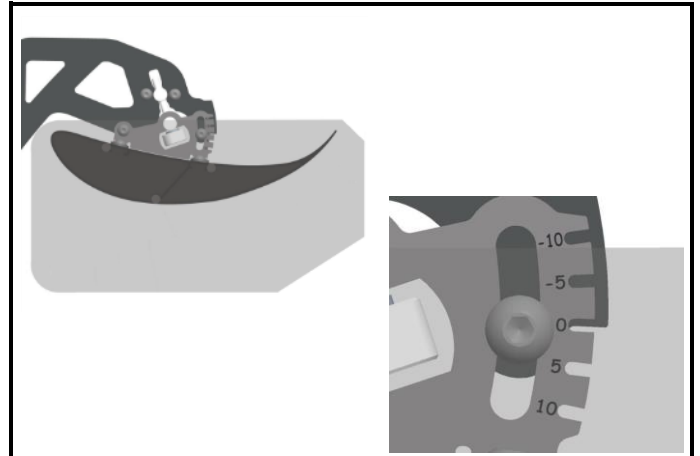

M15-1) Complete front splitter - dismounted



M15-2) Complete front splitter - dismounted



Make: **SEAT SPORT**

Model: **SEAT Leon Cup Racer V1 / DSG**



REAL FEDERACIÓN ESPAÑOLA DE AUTOMOVILISMO Extension N°  
Departamento Técnico  
Technical Department

M15-3) Complete front splitter brackets- front view



Minimum weight **11400** g (with bolts)

M15-4) Complete front splitter brackets - rear view



M15-5) Rear bumper brackets - front view

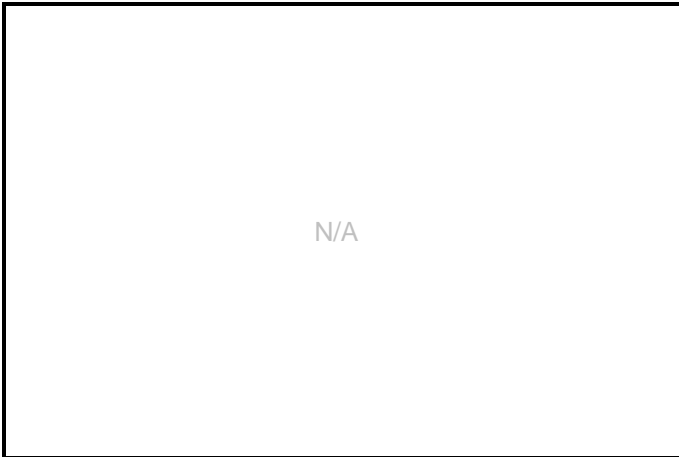

M15-6) Rear bumper brackets - rear view

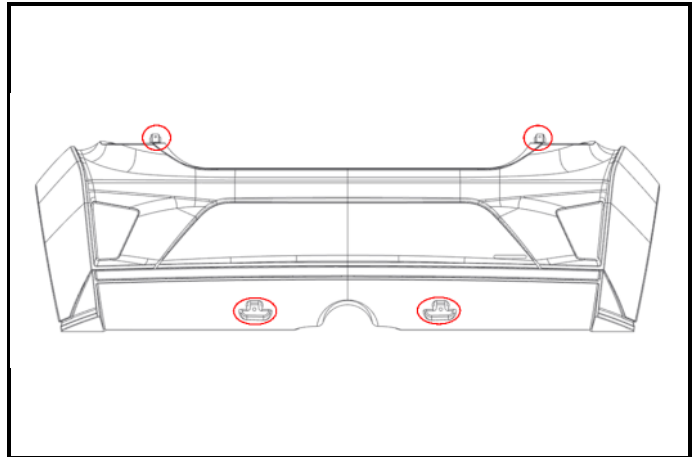

**XIII-N1) COMPLETE REAR WING DISMOUNTED**

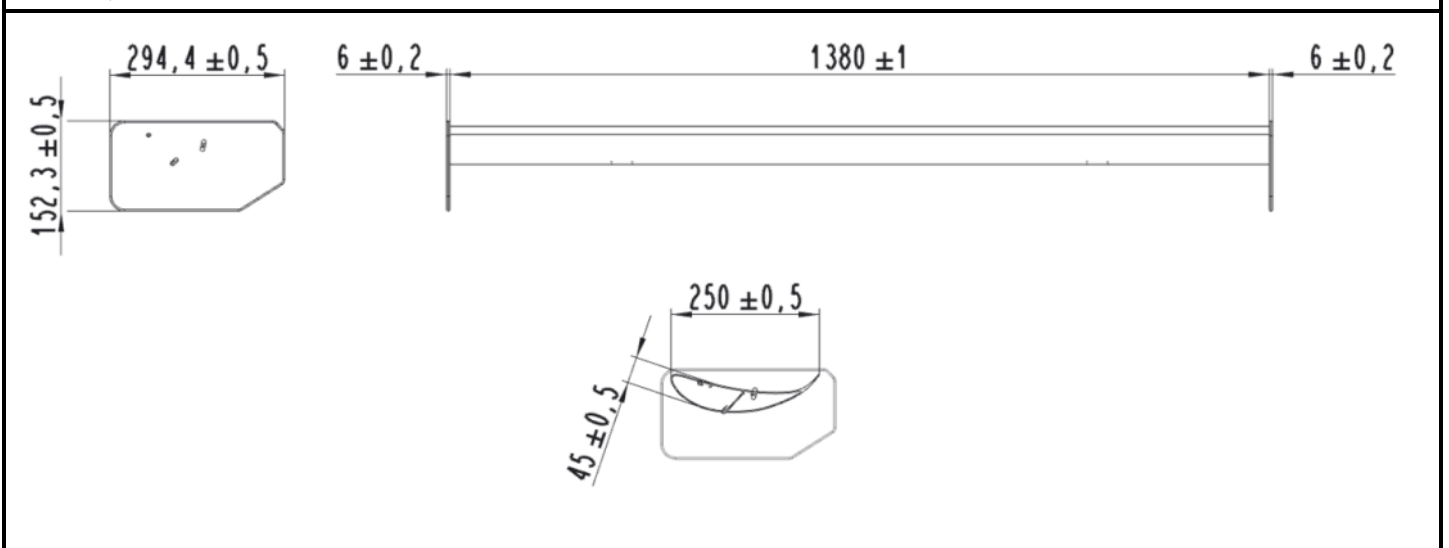



**XIII-N4) AERO PARTS MOUNTED ON CAR SEEN FROM THE SIDE (WITH LONGITUDINAL POSITION)**

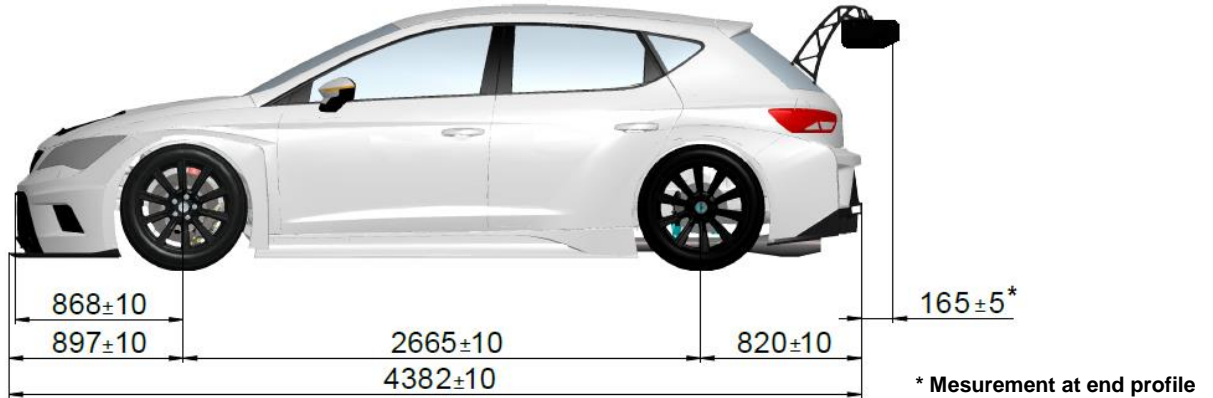

**903. CHASSIS (BODYSHELL)**

N1-1) Bare bodyshell – General view



N1-2) Bare bodyshell – General view



N1-3) Bare bodyshell – Engine compartment



N1-4) Bare bodyshell – Cockpit seen from windscreen opening



Make: **SEAT SPORT**Model: **SEAT Leon Cup Racer V1 / DSG**REAL FEDERACIÓN ESPAÑOLA  
DE AUTOMOVILISMO Extension N°  
Departamento Técnico  
Technical Department

N1-5) Bare bodyshell – Cockpit seen from rear window opening



N1-6) Bare bodyshell – Roof seen from cockpit



N1-7) Bare bodyshell – Luggage compartment



N1-8) Bare bodyshell – Seen from underneath

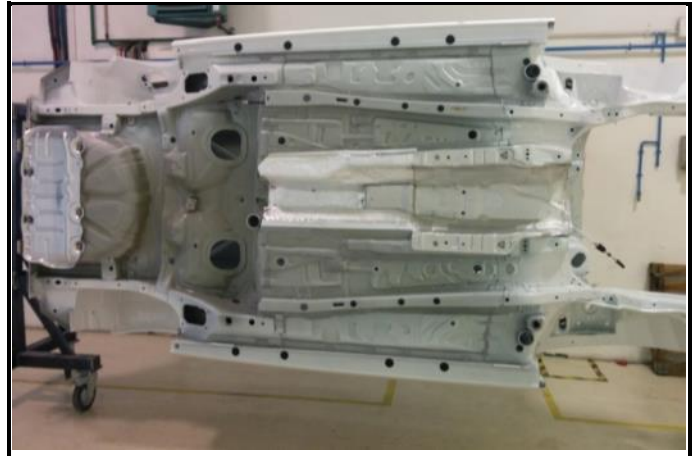

N1-9) Body shell identification plate



## MODIFICATIONS OF CHASSIS (BODYSHELL)

N3-1) Front bulkhead – Modification for steering column passage



N4-1) Front wheel housing – mounted



N4-2) Front member – Gearbox support



N4-3) Front suspension turret – top mount



N1-1) Seat Support



N10-4)



## COMPLEMENTARY INFORMATION

If supplementary information, sheets or pictures are requested, these should be added.

O1-1) Ballasts

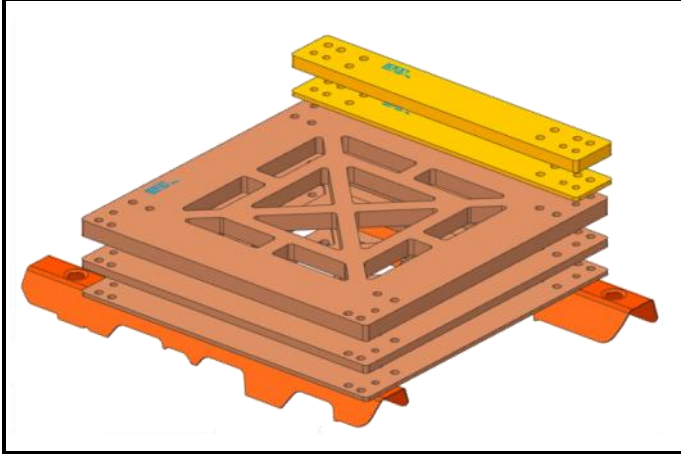

O1-2) Ballasts mounted on car

